



WORLD-CLASS LIFTING SOLUTIONS



VACUUM LIFTERS
MARCH 2025
Catalogue

Contents

Vacuhand Pro

Lift units, Vacuhand Pro	11
Extended handle, fixed	12
Extended handle, flexible	12
Filter	12
Vacuum hose	12
Silencing box	12
Weather/dust protection	12
Remote control for vacuum pump	13
Quick connection	13
Release valve	13
Angle joint / bottom swivel	13
Rectangular suction feet, Single	14
Rectangular suction feet, Double	14
Sack suction feet	14
Grid for Sack suction feet	14
Round suction feet	14
Yoke fixed, 2x rectangular suction feet	15
Yoke flexible, 2x rectangular suction feet	15
Yoke flexible, 4x rectangular suction feet	15
H-yoke fixed, 4x round bellow suction feet	16
H-Yoke flexible, 4x rectangular suction feet	16
H-Yoke flexible, 8x rectangular suction feet	16
Yoke accessories	16
Tube lifter, Vacuhand Pro	17
Pumps	17
Control units	17
Gaskets	17
Top swivels & Plastic adapters	18
Lift tubes & Protective socks	18
Lift tubes	18
Protective socks	18
Complete lift tube units	18
Gasket NBR	19
Gasket EPDM	19
Gasket for Suction feet, sacks	19
Gasket for suction feet round	19

Spare parts

Spare parts Vacuhand Pro	32
Spare parts Easyhand Rapid II	33
Spare parts Easyhand Pro	34
Spare parts Easyhand M	35
Spare parts Easyhand M, Extended handle	36
Spare parts Filter unit	37
Spare parts Pump C	38
Spare parts Pump D	39
Spare parts Pump K	40
Spare parts Pump I	41
Spare parts Pump F	42
Spare parts Pump G	43
Spare parts Pump H	44
Spare parts Easyhand Pro Rapid (legacy version)	45
Assembly legend Vacuhand	46
Assembly legend Easyhand	47

Easyhand Rapid II / Pro / M

Lift units, Easyhand Rapid II	21
Lift units, Easyhand Pro	22
Lift units, Easyhand M	23
Extended handle, fixed, for Easyhand M	24
Extended handle, flexible, for Easyhand M	24
2-hand handle	24
Filter	24
Vacuum hose	24
Silencing box	25
Remote control for vacuum pump	25
Quick connection	25
Release valve	25
Angle joint / bottom swivel	25
Rectangular suction feet, single	26
Round bellow suction feet, standard	26
Round bellow suction feet, Basic	26
Sack Suction feet	26
Grid for sack suction feet	26
Yoke fixed, 2x rectangular suction feet	27
Yoke flexible, 2x rectangular suction feet	27
H-yoke fixed, 4x round bellow suction feet	27
H-yoke fixed, 6x round bellow suction feet	27
Tube lifter, Easyhand Rapid II	28
Tube lifter, Easyhand Pro	28
Tube lifter, Easyhand M	28
Hose connection, Top swivel	28
Pumps	29
Control units	29
Gaskets	29
Top swivels	30
Plastic adapters	30
Lift tubes	30
Protective socks	30
Complete lift tube units	31
Gasket for Suction feet, sacks	31

Vacuum lifters



	EASYHAND RAPID II	EASYHAND PRO	EASYHAND M	VACUHAND PRO
Max. load (kg)	55	55	55	250
Grip	Single-handed grip	Single-handed grip	Extended single-handed grip w. two-handed option	Two-handed grip w. extended option
Tube diameter (mm)	100 / 120	60 / 80 / 100 / 120	60 / 80 / 100 / 120	140 / 160 / 180 / 200 / 230 / 250 / 300
Control	The unit with load rises, the engaged controller lowers the load	When the controller is engaged, the load is lifted/lowered.	When the controller is engaged, the load is lifted/lowered.	When the controller is engaged, the load is lifted/lowered.
Release	Quick release	Unloaded release	Unloaded release	Unloaded release
Vacuum source	Electric vacuum pump K & I	Electric vacuum pump or pneumatic ejector A, B, C, D, K & I	Electric vacuum pump or pneumatic ejector A, B, C, D, K & I	Electric vacuum pump F, G & H
Objects	For specific application: fast cardboard box handling, luggage etc. at workstations in logistics and distribution	For different types of handled objects: cardboard boxes, sheet materials, smaller bags etc.	For different types of handled objects: cardboard boxes, sheet materials, smaller bags etc.	For different types of handled objects: cardboard boxes, sheet materials, bags etc.

**Tube diameter
(mm)**

**Max. load
(kg)**

60	80	100	120	140	160	180	200	230	250	300
20	35	45	55	60	80	100	130	170	200	250

Dimension and configure your vacuum lifter

Hose diameter and maximum load

The diagram shows a recommended load for each hose diameter and pump. The blue bars represent non porous lifting objects and the red bars represent porous lifting objects.

Since the porosity of the lifting object affects the lifting force, it is not possible to ensure the maximum load for anything other than completely non porous lifting objects. The stacks for porous lifting objects should therefore only be seen as a guide value.

Movomech always recommends that a test lift be carried out to determine that the correct combination of hose diameter and pump is used, so that the lifting object can be handled in a safe and secure manner.

Also remember to add the weight of the lifting tool when calculating your maximum load.

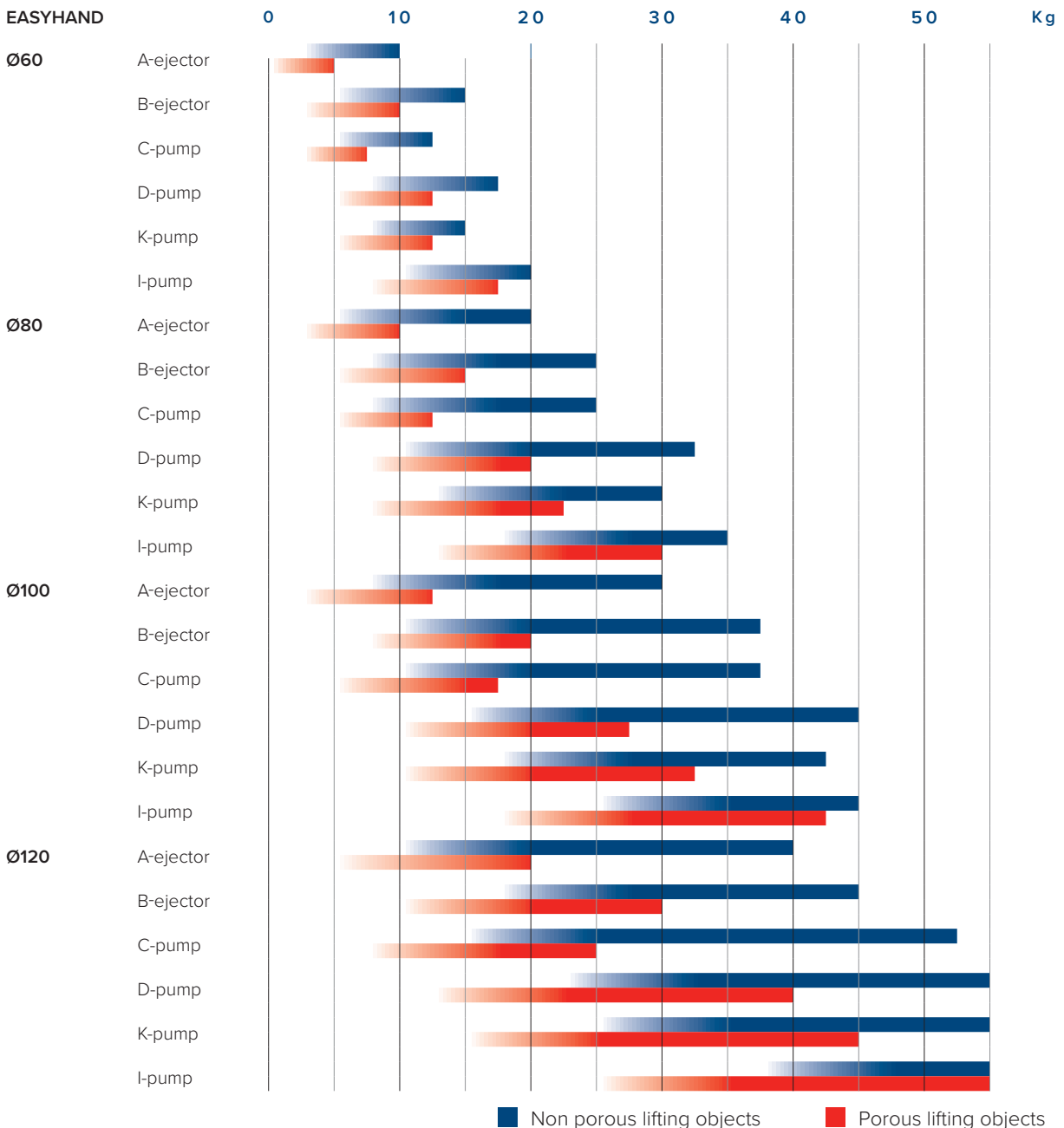

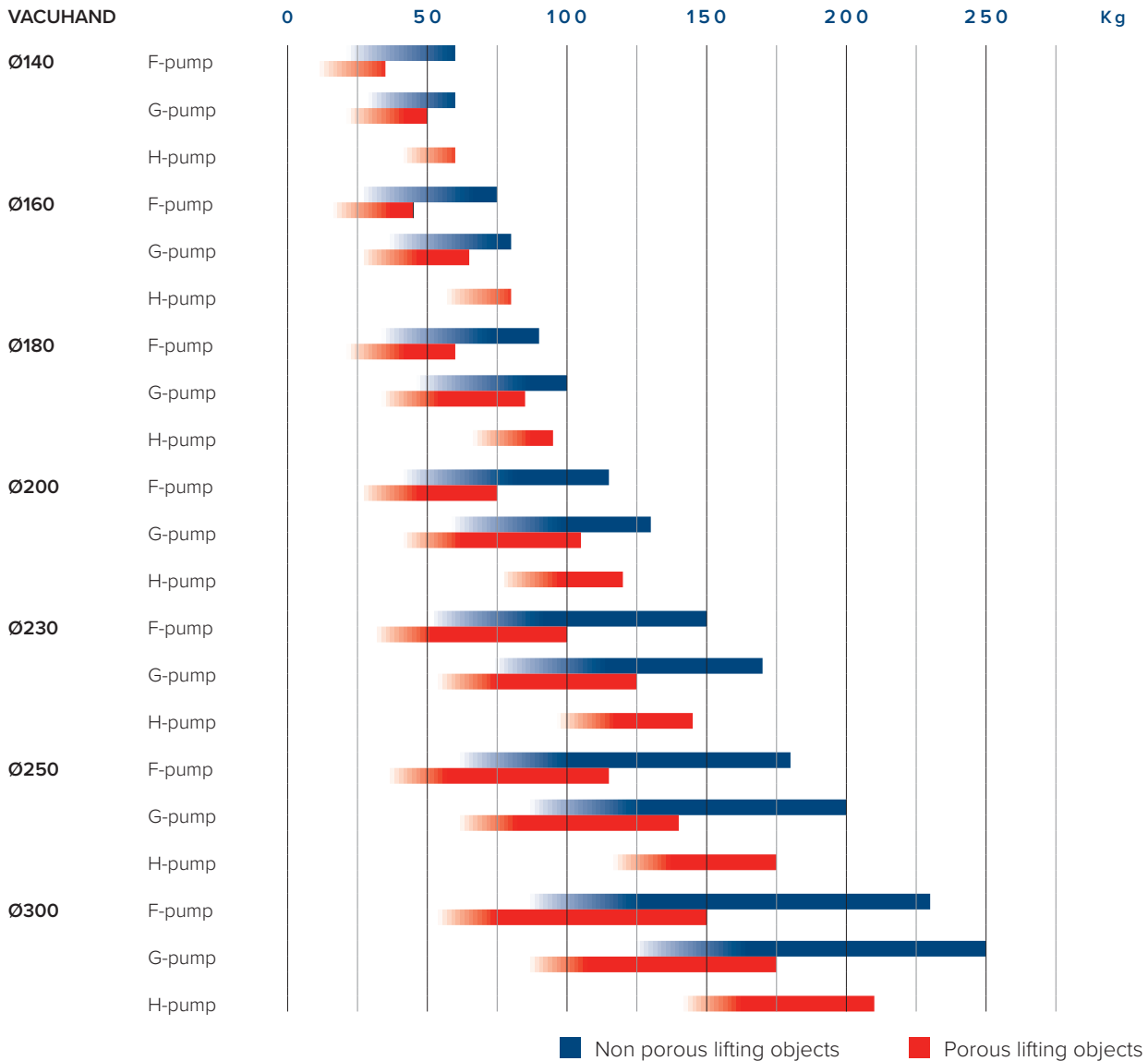

Example Easyhand:

You want to handle a carton weighing 35 kg, the yoke weighs 2.5 kg.

According to the bars for porous lifting objects, a Ø120 tube with a D pump can do the job, but you are close to the limit. A test lift allows you to determine with certainty whether the D pump is capable of lifting the carton, or whether you must choose a stronger pump.

You want to handle a lacquered sheet metal part that weighs 24 kg, the yoke weighs 3 kg.

According to the bars for non porous lifting objects, a Ø80 tube with a D pump should do the job. If you instead choose a Ø100 tube with a C pump, you get a larger safety margin and a smoother lifting movement.

Example Vacuhand:

You have to handle a sack weighing 25 kg, the weight of the sack suction foot is so low that you can ignore it.

When it comes to very porous lifting objects, you have to look towards the left part of the porous bars. A Ø140 tube with G pump seems to do the job.

You must handle a porous wooden board that weighs 75 kg, the yoke weighs 7 kg.

According to the bars for porous lifting objects, a Ø180 hose with a G pump can do the job. Since the porosity of the wood board is an unknown factor, you need to do a test lift to determine for sure if the combination of hose and tube is right for this job.

Pump - based on lifting object

Most materials that can be handled with a vacuum lift have a certain degree of porosity, i.e. some air leaks through the lifting object into the lifting tube. How porous a specific material is can be impossible to determine without a test lift. One cardboard box can be relatively non-porous and another can be very porous, as the diagram below illustrates.

It is important to dimension the pump according to this leakage. The stronger pumps have a very high flow and are therefore suitable for lifting porous objects. Their high flow compensates for the air that leaks into the lifting tube through the lifting object. The weaker pumps have a lower flow and are suitable for non-porous lifting objects.

Why then don't you always choose a stronger pump? The pumps are cooled by the air that passes through the lift and the stronger the pump, the more heat it develops. Lifting a completely non-porous lifting object with a too strong pump thus increases the risk of the pump becoming too hot. You also cannot always choose a weaker pump as it may have difficulty holding a porous lifting object. There, instead, the higher flow that the stronger pumps provide is needed.

Choose the right pump, based on the lifting object, and you will get a well-functioning lift that will last a long time.

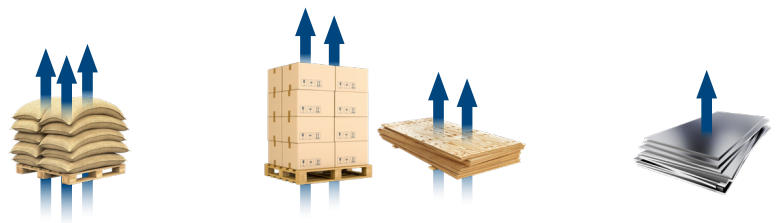

LIFTING OBJECT

Very porous

Porous

Non-porous

	Power (kW)	Flow (m ³ /h)
Sacks		
Cardboard boxes and wooden boards		
Sheet metal		
EASYHAND		
A-ejector	-	24
B-ejector	-	36
C-pump	0,75	25
D-pump	1,3	40
K-pump	2,2	55
I-pump	2,2	78
VACUHAND		
F-pump	2,2	142
G-pump	3,0	171
H-pump	5,5	235

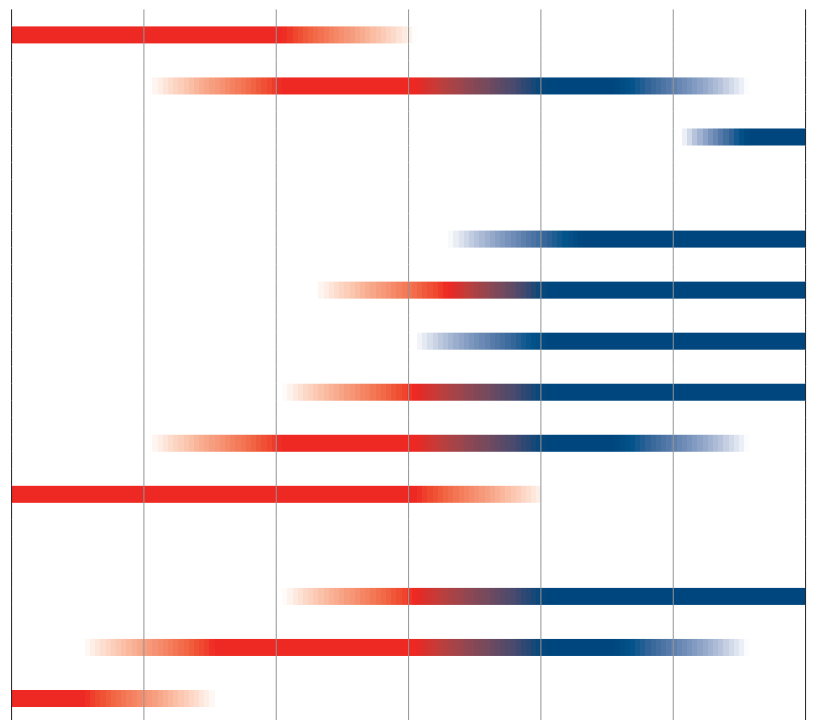

Lifting speed and safety

The choice of hose diameter not only affects the lifting force but also the lifting speed. The time it takes for the pump to evacuate the volume of air that the lift hose holds determines the lift speed.

In other words, a vacuum lifter with a smaller hose diameter is faster than a vacuum lifter with a larger hose diameter. A pump with a high flow gives a faster lift than if you choose a pump with a lower flow.

But speed is not always something to strive for, usually you want a calm and smooth lifting movement and then it is an advantage to choose a larger lifting hose. As a rule of thumb, you should therefore choose one size larger lifting hose than is required. Then you also get an extra safety margin in lifting force.

Technical data

		EASYHAND M / PRO / PRO RAPID		EJECTOR			PUMP	
		A	B	C	D	K	I	
Min work pressure	bar	6	6					
Flow	m ³ /h	24	36	25	40	55	78	
Work temperature	°C	5-40 (indoor use)						
Noise level ¹ excl. silencing hood	dB(A)	69	72	62	67	71	76	
Noise level ¹ incl. silencing hood	dB(A)			<52	<57	<60	<62	
Motor output	kW			0,75	1,3	2,2	2,2	
Voltage	V			400	400	400	400	
Fuse	A			10	10	10	10	
Weight pump	kg			26	39	76	78	
Weight pump incl. silencing hood	kg			59	81	106	108	
LxWxH pump excl. silencing hood	mm			505x260x290	572x280x290	702x353x328	702x353x328	
LxWxH pump incl. silencing hood	mm			808x448x348	808x448x348	856x504x567	856x504x567	
Min lifting height Z (hose L 2500 / 4000) ²	mm	approx. 1700 / 3000						

		VACUHAND			PUMP		
		F	G	H			
Flow	m ³ /h	142	171	235			
Work temperature	°C	5-40 (indoor use)					
Noise level excl. silencing hood	dB(A)	75	80	86			
Noise level incl. silencing hood	dB(A)	68	69	74			
Motor output	kW	2,2	3	5,5			
Voltage	V	400	400	400			
Fuse	A	10	16	25			
Weight pump	kg	40	48	94			
Weight pump incl. silencing hood	kg	80	88	136			
LxWxH pump excl. silencing hood	mm	555 x 266 x 474	650 x 315 x 512	697 x 365 x 540			
LxWxH pump incl. silencing hood	mm	850 x 518 x 598	850 x 565 x 675	850 x 565 x 675			
Min lifting height Z (hose L 2500 / 4000) ¹	mm	approx. 1700 / 3000					

Choice of suction feet

Choose the type of suction feet or yoke that suits the object.

Rectangular suction feet works great for most flat surfaces.

Round suction feet have a bellow that shapes after the lift object.

Sack suction feet works great for lifting sacks and bags.

Check that the suction foot is of the right dimension in relation to the selected lifting tube size in the chart below.

- Indicates that the suction foot is safe to use on horizontal lifts where the center of gravity is not offset from the lifter.
- Indicates that the suction foot is safe to use on 90° tilted lifts as well as horizontal lifts.

- Indicates that the suction foot is safe to use on 90° tilted lifts as well as horizontal lifts but can be hard to release, consider adding a release valve.

- Indicates that the suction foot is unsuitable to use.

Type	Size	60	80	100	120	140	160	180	200	230	250	300
Rectangular suction feet	85x200	●	○	-	-							
	125x320	●●	●	●	○							
	140x200	●●	●	○	○							
	200x290					○	○	-	-	-	-	-
	210x330					●	○	○	-	-	-	-
Round bellow suction feet	Ø150	●	○	○	-							
	Ø200	●●	●	○	○							
Sack suction feet * Designed for luggage	185x115	●	○	-	-							
	290x154	●●	●	●	○							
	275x175	●●	●	●	○							
	245x125 *	●●	●	○	-							
	280x175					○	-	-	-	-	-	-
	375x210					●	○	○	-	-	-	-
	455x260					●	●	○	○	-	-	-
Round suction feet	Ø230					○	-	-	-	-	-	-
	Ø250					○	-	-	-	-	-	-
	Ø280					●	○	-	-	-	-	-
	Ø300					●	○	○	-	-	-	-
	Ø320					●	●	○	-	-	-	-
	Ø360					●	●	○	○	-	-	-
	Ø400					●●	●	●	○	○	○	-
Yoke 2x rectangular suction feet	85x200	●●	●	●	○							
	140x200					○	○	-	-	-	-	-
	120x315					●	○	○	-	-	-	-
	200x290					●	●	●	○	○	-	-
Yoke 4x rectangular suction feet	85x200					●	○	○	-	-	-	-
	120x315					●●	●	●	●	○	○	-
	200x290					●●	●●	●●	●	●	●	○
Yoke 8x rectangular suction feet	85x200					●	○	○	○	○	○	-
	140x200					●●	●●	●	○	○	○	○
Yoke 2x round bellow suction feet	Ø110	●	●	○	-							
	Ø150	●●	●	●	●	○	-	-	-	-	-	-
Yoke 4x round bellow suction feet	Ø75	●	○	○	-							
	Ø110	●●	●	●	●	○	-	-	-	-	-	-
	Ø150					●	○	○	-	-	-	-
Yoke 6x round bellow suction feet	Ø75	●●	●	●	○							

Yoke, adjustable range

Our adjustable yokes can be reduced to approximately 40 % of its total length and width. Contact us before ordering a yoke that you need to reduce beyond 40 % to verify its function.

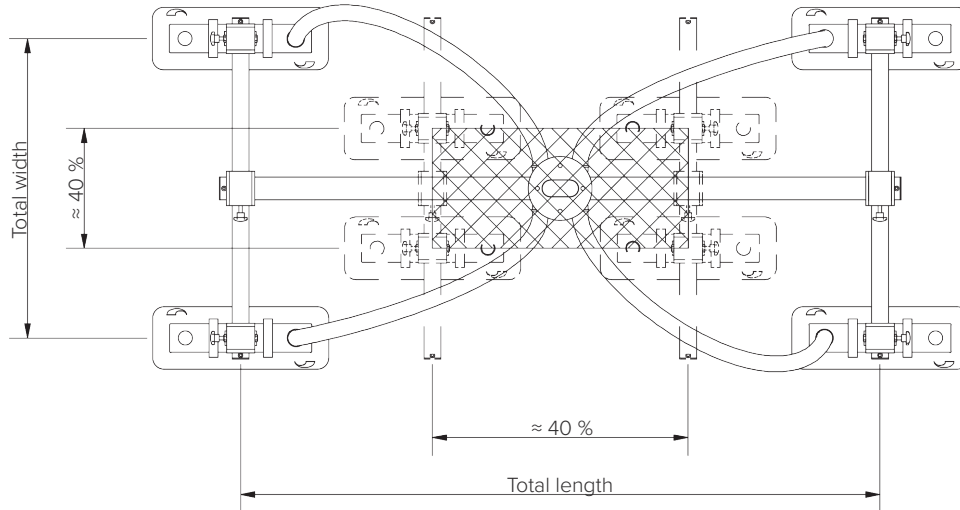

Movomech resources

Whenever you need to show a customer a lifting solution, remember that you are always free to use our media resources. Share our Youtube videos, link to a product page on our website or insert an image from our partner pages into your quote.

And keep in touch with us through our social media, we'd love your company!

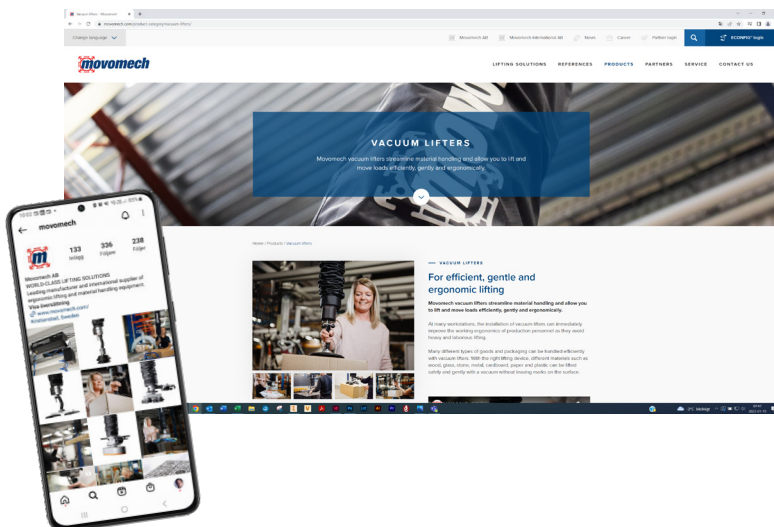

VACUHAND PRO

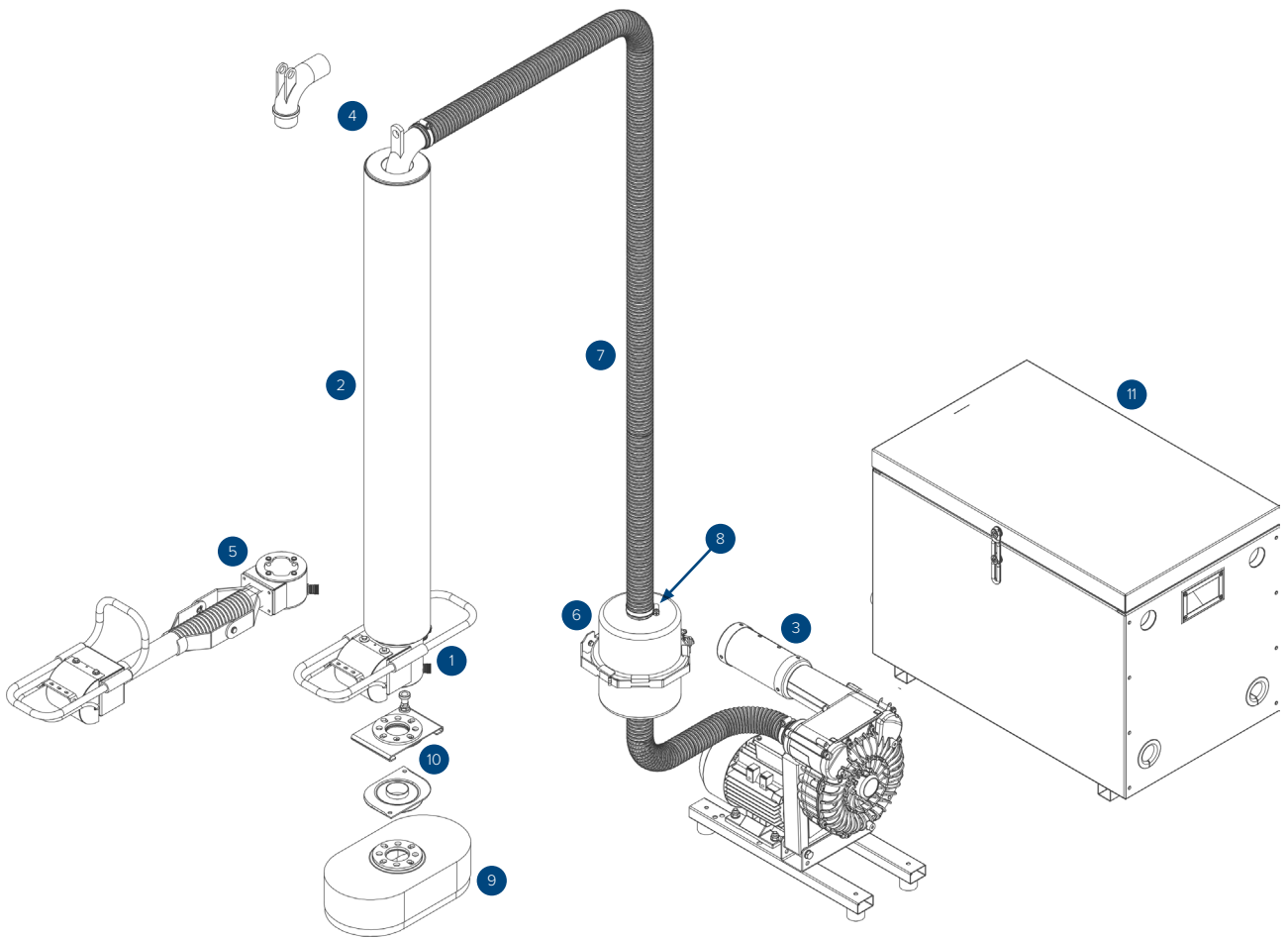

Vacuhand Pro can be configured in a vast amount of ways to fit a specific purpose.

It can be purchased in a kit as a base to build your lift system from, including:

- Control unit (1)
- Lift tube (2)
- Pump (3)

The Article No. in the price list includes the standard configuration with a 2,5 m lift tube, a 1 lug swivel (4) and a standard control unit. If we look at the article number (in this example for a Vacuhand Pro 140 with an F pump 640714-1FAA) it consists of the following components:

6407	14	-	1	F	AA*
Lift tube (14 = Ø140)		No. of swivel lugs (1 or 2)		Pump (F, G or H)	
Lift tube length (AA=2,5 m, 4A=4,0 m)					

* The last A changes to a Z for the H-pump

If you want a kit with a Vacuhand Pro 140 and an F pump, but you want the 2-lug swivel and a 4,0 m lift tube, the Article No. would look like this: 640714-2F4A.

If you would like the extended handle (5), add the Article No. of the extended handle you want on your order and the control unit will be exchanged to include the operating housing for the extended handle. The Article No. for the lifter doesn't need to be changed.

To complete the system, add the following components:

- Filter (6)
- Vacuum tube (7)
- Hose clamp (8)
- Suction cup (9)

Optional accessories examples:

- Quick connection (10)
- Silencing box (11)

CONTENT

Lift units, Vacuhand Pro	7	Yoke flexible, 4x rectangular suction feet	11
Extended handle, fixed	8	H-yoke fixed, 4x round bellow suction feet	12
Extended handle, flexible	8	H-Yoke flexible, 4x rectangular suction feet	12
Filter	8	H-Yoke flexible, 8x rectangular suction feet	12
Vacuum hose	8	Yoke accessories	12
Silencing box	8	Tube lifter, Vacuhand Pro	13
Weather/dust protection	8	Pumps	13
Remote control for vacuum pump	9	Control units	13
Quick connection	9	Gaskets	13
Angle joint / bottom swivel	9	Top swivels & Plastic adapters	14
Release valve	9	Lift tubes & Protective socks	14
Rectangular suction feet, Single	10	Lift tubes	14
Rectangular suction feet, Double	10	Protective socks	14
Sack suction feet	10	Complete lift tube units	14
Grid for Sack suction feet	10	Gasket NBR	15
Round suction feet	10	Gasket EPDM	15
Yoke fixed, 2x rectangular suction feet	11	Gasket for Suction feet, sacks	15
Yoke flexible, 2x rectangular suction feet	11	Gasket for suction feet round	15

STAINLESS STEEL

Categories marked with **Available in SS** are available in stainless steel. Add -RF after the article no. (ex. 640716-1GAA-RF). Add cost acc. to price list for Vacuhand lifters and price x2 for all other equipment. Delivery time 8 weeks. Other equipment is available in stainless steel upon request.

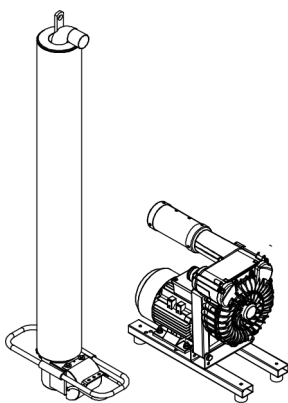
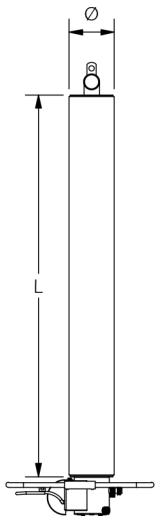

Vacuhand Pro with pump F

LIFT UNITS, VACUHAND PRO Available in SS

Pump	Length (L)	Diameter (Ø)	Article No.
BE 2,2 kW side (F)	2500 mm	140 mm	640714-1FAA
		160 mm	640716-1FAA
		180 mm	640718-1FAA
		200 mm	640720-1FAA
BE 3,0 kW side (G)	2500 mm	140 mm	640714-1GAA
		160 mm	640716-1GAA
		180 mm	640718-1GAA
		200 mm	640720-1GAA
		230 mm	640723-1GAA
		250 mm	640725-1GAA
BE 5,5 kW side (H)	2500 mm	300 mm	640730-1GAA
		180 mm	640718-1HAZ
		200 mm	640720-1HAZ
		230 mm	640723-1HAZ
BE 2,2 kW side (F)	4000 mm	250 mm	640725-1HAZ
		300 mm	640730-1HAZ
		140 mm	640714-1F4A
BE 3,0 kW side (G)	4000 mm	160 mm	640716-1F4A
		180 mm	640718-1F4A
		200 mm	640720-1F4A
		230 mm	640723-1G4A
BE 5,5 kW side (H)	4000 mm	140 mm	640714-1G4A
		160 mm	640716-1G4A
		180 mm	640718-1G4A
		200 mm	640720-1G4A
BE 2,2 kW side (F)	4000 mm	230 mm	640723-1G4A
		180 mm	640718-1H4Z
		200 mm	640720-1H4Z
BE 5,5 kW side (H)	4000 mm	230 mm	640723-1H4Z

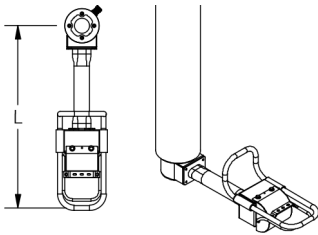

EXTENDED HANDLE, FIXED Available in SS

Length (L)	Article No.
400 mm	640100-004
600 mm	640100-006
800 mm	640100-008
1200 mm	640100-012

Add the Article No. of the extended handle you want on your order and the control unit will be exchanged to include the operating housing for the extended handle. The Article No. for the lifter doesn't need to be changed.

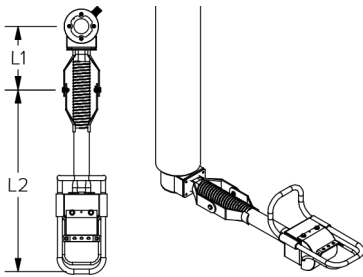

EXTENDED HANDLE, FLEXIBLE Available in SS

Length (L1)	Length (L2)	Article No.
200 mm	400 mm	640110-0204
200 mm	600 mm	640110-0206
400 mm	400 mm	640110-0404
400 mm	600 mm	640110-0406
800 mm	400 mm	640110-0804
800 mm	600 mm	640110-0806

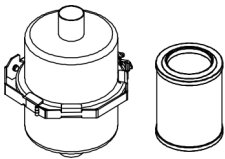

FILTER Available in SS

Description	Article No.
Filter unit for Ø50 mm hose	644001
Filter insert (included in filter unit)	841833

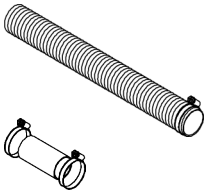

VACUUM HOSE

Description	Article No.
Hose Ø50 mm (price/m) (max length/roll 50 m)	641501-050
Hose clamp Ø44-56 mm	840503
Joint set Ø50-hose	641501-050-02

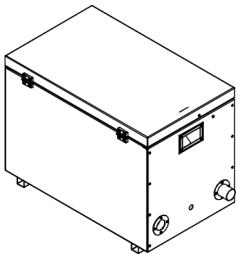

SILENCING BOX Available in SS

Description	Article No.
For pump F	860062
For pump G & H	860065

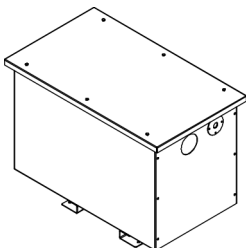

WEATHER/DUST PROTECTION

Description	Article No.
For pump F	860060
For pump G & H	860066

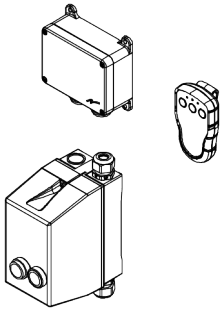

REMOTE CONTROL FOR VACUUM PUMP

Description		Article No.
Radio control 7,0-10,0A	For pump H	744976
Radio control 4,0-6,0A	For pumps F & G	744977

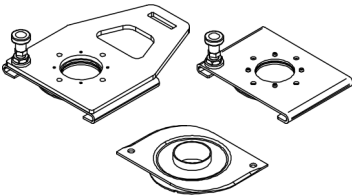

QUICK CONNECTION Available in SS

Description	Height	Article No.
Upper, with suspension		841318
Upper	Lower + upper 27 mm	242100
Lower		641001

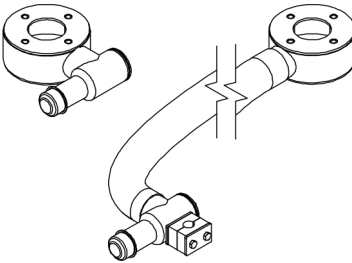

RELEASE VALVE Available in SS

Description	Height	Article No.
Standard	50 mm	642520
Extended	50 mm	642521

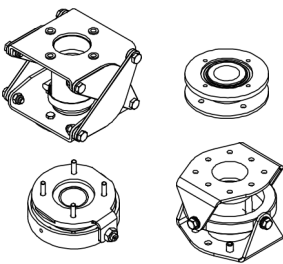

ANGLE JOINT / BOTTOM SWIVEL Available in SS

Description	Height	Article No.
Angle joint 90°	101 mm	641009
Bottom swivel	33 mm	642501
Bottom swivel, long screws *	33 mm	642501-50
Bottom swivel 4-position	43 mm	642502
Bottom swivel 4-position, long screws *	43 mm	642502-50
Universal joint	98 mm	241170

* Swivels with long screws are used when combining a swivel with a release valve.

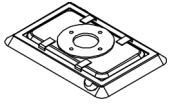

RECTANGULAR SUCTION FEET, SINGLE

Length	Width	Height	Article No.
290 mm	200 mm	25 mm	641707
330 mm	210 mm	25 mm	641706

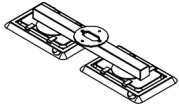

RECTANGULAR SUCTION FEET, DOUBLE

Length	Width	Height	Article No.
290 mm	200 mm	65 mm	641711

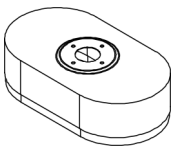

SACK SUCTION FEET Available in SS

Length	Width	Height	Article No.
280 mm	175 mm	105 mm	642204
375 mm	210 mm	105 mm	642205
455 mm	260 mm	107 mm	642208

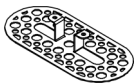

GRID FOR SACK SUCTION FEET Available in SS

Description	Article No.
Grid for 642204	642204-01
Grid for 642205	642205-01
Grid for 642208	642208-01

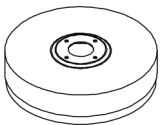

ROUND SUCTION FEET Available in SS

Diameter	Height	Article No.
230 mm	76 mm	642230
250 mm	76 mm	642250
280 mm	76 mm	642280
300 mm	76 mm	642300
320 mm	76 mm	642320
360 mm	76 mm	642360
400 mm	76 mm	642400

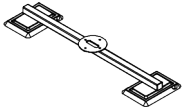

YOKE FIXED, 2X RECTANGULAR SUCTION FEET

Suction feet		Yoke		
Length	Width	Length	Height	Article No.
200 mm	140 mm	500 mm	63 mm	642408-050
		800 mm	63 mm	642408-080
		1000 mm	63 mm	642408-100
315 mm	120 mm	500 mm	63 mm	642409-050
		800 mm	63 mm	642409-080
		1000 mm	63 mm	642409-100
		1200 mm	63 mm	642409-120

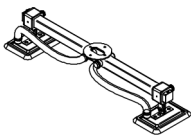

YOKE FLEXIBLE, 2X RECTANGULAR SUCTION FEET

Suction feet		Yoke		
Length	Width	Length	Height	Article No.
200 mm	140 mm	500 mm	140 mm	642401-050
		800 mm	140 mm	642401-080
		1200 mm	140 mm	642401-120
315 mm	120 mm	500 mm	140 mm	642402-050
		800 mm	140 mm	642402-080
		1200 mm	140 mm	642402-120
290 mm	200 mm	500 mm	140 mm	642403-050
		800 mm	140 mm	642403-080
		1200 mm	140 mm	642403-120

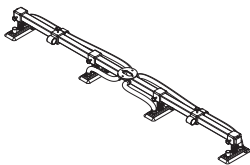

YOKE FLEXIBLE, 4X RECTANGULAR SUCTION FEET

Suction feet		Yoke		
Length	Width	Length	Height	Article No.
200 mm	85 mm	500 mm	139 mm	642410-050
		800 mm	139 mm	642410-080
		1200 mm	139 mm	642410-120
		1800 mm	139 mm	642410-180
315 mm	120 mm	500 mm	139 mm	642412-050
		800 mm	139 mm	642412-080
		1200 mm	139 mm	642412-120
		1800 mm	139 mm	642412-180

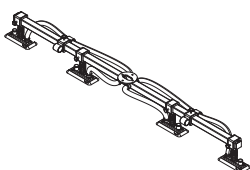

YOKE FLEXIBLE, INLINE, 4X RECTANGULAR SUCTION FEET

Suction feet		Yoke		
Length	Width	Length	Height	Article No.
200 mm	85 mm	800 mm	169 mm	642411-080
		1200 mm	169 mm	642411-120
		1800 mm	169 mm	642411-180
315 mm	120 mm	800 mm	169 mm	642413-080
		1200 mm	169 mm	642413-120
		1800 mm	169 mm	642413-180

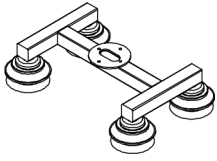

H-YOKE FIXED, 4X ROUND BELLOW SUCTION FEET

Diameter	Length	Width	Height	Article No.
Ø110 mm	370 mm	280 mm	122 mm	642425-007
	500 mm	330 mm	122 mm	642425-009
Ø150 mm	350 mm	350 mm		642425-021

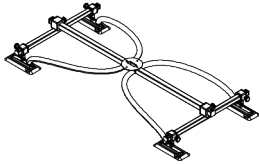

H-YOKE FLEXIBLE, 4X RECTANGULAR SUCTION FEET

Suction feet		Yoke			Article No.
Length	Width	Length	Width	Height	
200 mm	85 mm	500 mm	600 mm	171 mm	642420-0506
		800 mm	600 mm	171 mm	642420-0806
		1200 mm	600 mm	171 mm	642420-1206
315 mm	120 mm	500 mm	600 mm	171 mm	642422-0506
		800 mm	600 mm	171 mm	642422-0806
		1200 mm	600 mm	171 mm	642422-1206
290 mm	200 mm	500 mm	600 mm	171 mm	642423-0506
		800 mm	600 mm	171 mm	642423-0806
		1200 mm	600 mm	171 mm	642423-1206

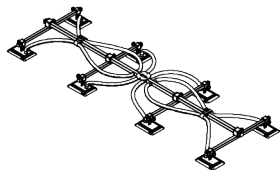

H-YOKE FLEXIBLE, 8X RECTANGULAR SUCTION FEET

Suction feet		Yoke			Article No.
Length	Width	Length	Width	Height	
200 mm	85 mm	2200 mm	600 mm	171 mm	642427-2206
		2800 mm	1000 mm	171 mm	642427-2810
200 mm	140 mm	2200 mm	600 mm	171 mm	642428-2206
		2800 mm	1000 mm	171 mm	642428-2810

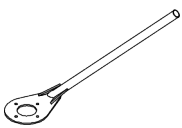

YOKE ACCESSORIES

Description	Height	Article No.
Yoke tilt handle	4 mm	641012

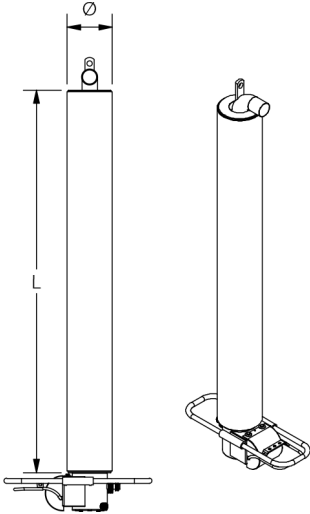

TUBE LIFTER, VACUHAND PRO

Length (L)	Diameter (Ø)	Article No.
2500 mm	140 mm	640714-10
	160 mm	640716-10
	180 mm	640718-10
	200 mm	640720-10
	230 mm	640723-10
	250 mm	640725-10
	300 mm	640730-10
4000 mm	140 mm	640714-14
	160 mm	640716-14
	180 mm	640718-14
	200 mm	640720-14
	230 mm	640723-14

Change the article no. from -10 or -14 to -20 or -24 to get a 2-lug swivel.

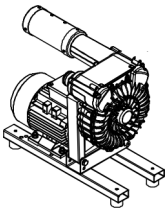

PUMPS

Description	Article No.
Electric BE 2,2 side	660001-F22
Electric BE 3,0 side	660001-G30
Electric FPZ 5,5 side	660001-H55Z

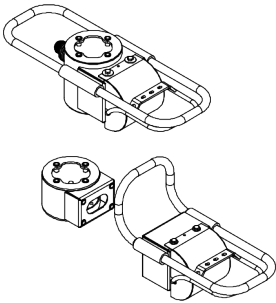

CONTROL UNITS

Description	Height	Article No.
Vacuhand Pro Standard	124 mm	640000
Vacuhand Pro Extended Housing	78 mm	640201
Vacuhand Pro Extended Handle	-	640100

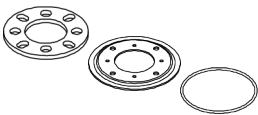

GASKETS

Description	Height	Article No.
Gasket lift/tool	6 mm	641002
Gasket quick conection upper	-	641007
O-ring quick connection upper	-	641008

TOP SWIVELS & PLASTIC ADAPTERS

	Top swivel 1 ear	Top swivel 2 ears	Plastic adapter lower
Diameter	Article No.	Article No.	Article No.
140 mm	640320-10	640320-20	640366
160 mm	640321-10	640321-20	640367
180 mm	640322-10	640322-20	640368
200 mm	640323-10	640323-20	640369
230 mm	640324-10	640324-20	640370
250 mm	640325-10	640325-20	640371
300 mm	640326-10	640326-20	640372
			Gasket 641003

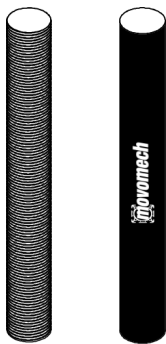
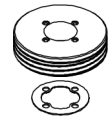
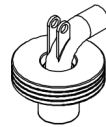
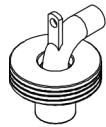

LIFT TUBES & PROTECTIVE SOCKS

		Lift tubes	Protective socks
Length	Diameter	Article No.	Article No.
2500 mm	140 mm	640461	6050464
	160 mm	640471	6050465
	180 mm	640481	6050466
	200 mm	640491	6050467
	230 mm	640499	6050469
	250 mm	640504	6050470
	300 mm	640514	6050471
4000 mm	140 mm	640461-04	6050554
	160 mm	640471-04	6050555
	180 mm	640481-04	6050556
	200 mm	640491-04	6050557
	230 mm	640499-04	6050558

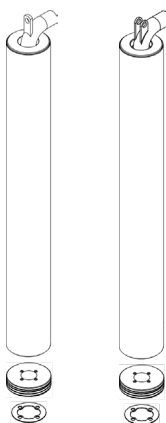

COMPLETE LIFT TUBE UNITS

		With top swivel 1 ear	With top swivel 2 ears
Length	Diameter	Article No.	Article No.
2500 mm	140 mm	640465-10	640465-20
	160 mm	640475-10	640475-20
	180 mm	640485-10	640485-20
	200 mm	640495-10	640495-20
	230 mm	640498-10	640498-20
	250 mm	640505-10	640505-20
	300 mm	640515-10	640515-20
4000 mm	140 mm	640465-14	640465-24
	160 mm	640475-14	640475-24
	180 mm	640485-14	640485-24
	200 mm	640495-14	640495-24
	230 mm	640498-14	640498-24

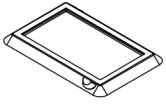

GASKET NBR Suitable for general indoor use, oil resistant, standard for all our suction feet

Length	Width	Article No.
200 mm	85 mm	860038-10
200 mm	140 mm	860027-10
290 mm	200 mm	860037-10
315 mm	120 mm	860048-10
315 mm	210 mm	860039-10

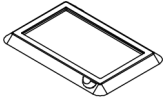

GASKET EPDM Suitable for general outdoor use

Length	Width	Article No.
200 mm	85 mm	860038-01
200 mm	140 mm	860027-01
290 mm	200 mm	860037-01
315 mm	120 mm	860048-01
315 mm	210 mm	860039-01

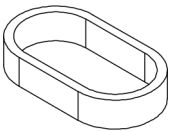

GASKET FOR SUCTION FEET, SACKS

Description	Length	Width	Article No.
Fits 642204	280 mm	175 mm	642204-03
Fits 642205	375 mm	210 mm	642205-03
Fits 642208	455 mm	260 mm	642208-03

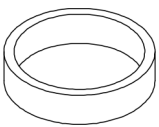

GASKET FOR SUCTION FEET ROUND

Description	Diameter	Article No.
Fits 642230	230 mm	642230-03
Fits 642250	250 mm	642250-03
Fits 642280	280 mm	642280-03
Fits 642300	300 mm	642300-03
Fits 642320	320 mm	642320-03
Fits 642360	360 mm	642360-03
Fits 642400	400 mm	642400-03

EASYHAND RAPID II / PRO / M

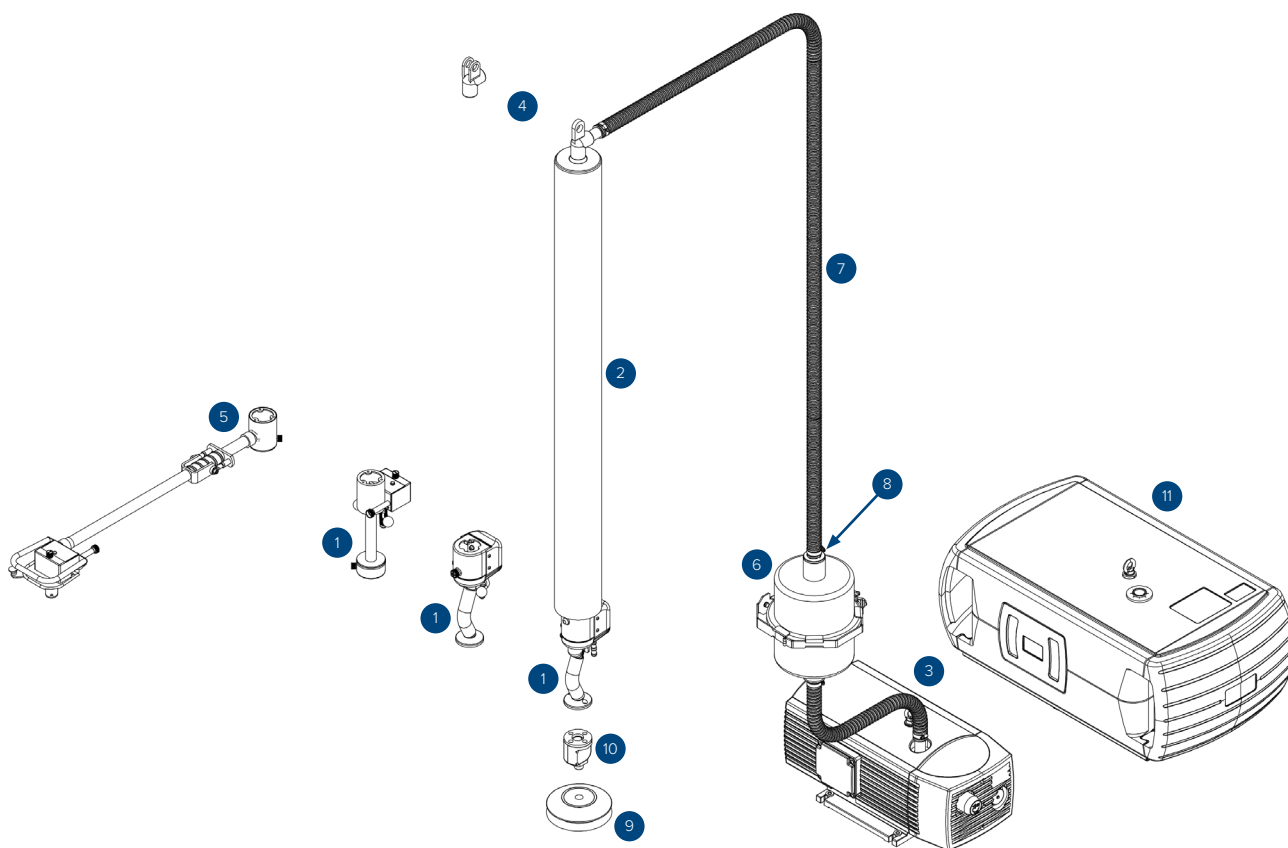

Easyhand series consists of Pro, Pro Rapid and M models. They can all be configured in a vast amount of ways to fit a specific purpose.

Regardless of model, it can be purchased in a kit as a base to build your lift system from, including:

- Control unit (1)
- Lift tube (2)
- Pump (3)

The Article No. in the price list includes the standard configuration with a 2,5 m lift tube, a 1 lug swivel (4) and a standard control unit. If we look at the article number (in this example for a Easyhand Pro 120 with a D pump 670712-1DAA) it consists of the following components:

6707	12	-	1	D	AA
Lift tube (12 = Ø120)					
No. of swivel lugs (1 or 2, 3 = ejector)					
Pump or ejector (A, B, C, D, K or I)					
Lift tube length (AA=2,5 m, 4A=4,0 m)					

If you want a kit with a Easyhand Pro 120 and a D pump, but you want the 2-lug swivel and a 4,0 m lift tube, the Article No. would look like this: 670712-2D4A.

If you would like the extended handle (5) (only available for the M model), add the Article No. of the extended handle you want on your order and the control unit will be exchanged to include the operating housing for the extended handle. The Article No. for the lifter doesn't need to be changed.

To complete the system, add the following components:

- Filter (6)
- Vacuum tube (7)
- Hose clamp (8)
- Suction cup (9)

Optional accessories examples:

- Combined angle joint 90° + bottom swivel (10)
- Silencing box (11)

CONTENT

Lift units, Easyhand Pro Rapid II 17
 Lift units, Easyhand Pro 18
 Lift units, Easyhand M 19
 Extended handle, fixed, for Easyhand M 20
 extended handle, flexible, for Easyhand M 20
 2-hand handle 20
 Filter 20
 Vacuum hose 20
 Silencing box 21
 Remote control for vacuum pump 21
 Quick connection 21
 Release valve 21
 Angle joint / bottom swivel 21
 Rectangular suction feet, single 22
 Round bellow suction feet 22
 Sack Suction feet 22
 Grid for sack suction feet 22
 Yoke fixed, 2x rectangular suction feet 23

Yoke flexible, 2x rectangular suction feet 23
 H-yoke fixed, 4x round bellow suction feet 23
 H-yoke fixed, 6x round bellow suction feet 23
 Tube lifter, Easyhand Pro Rapid 24
 Tube lifter, Easyhand Pro 24
 Tube lifter, Easyhand M 24
 Pumps 25
 Control units 25
 Gaskets 25
 Top swivels 26
 Plastic adapters 26
 Lift tubes 26
 Protective socks 26
 Complete lift tube units 27
 Gasket NBR 27
 Gasket EPDM 27
 Gasket for Suction feet, sacks 27

STAINLESS STEEL

Categories marked with **Available in SS** are available in stainless steel. Add -RF after the article no. (ex. 671710-11AA-RF). Add cost acc. to price list for Easyhand lifters and price x2 for all other equipment. Delivery time 8 weeks. Other equipment is available in stainless steel upon request.

LIFT UNITS, EASYHAND RAPID II Available in SS

Pump	Length (L)	Diameter (Ø)	Interface	Article No.
DV 60 vanes (K) (Ø32mm hose)	2 500 mm	100 mm	Ø150	672010-1KAA
		120 mm	Ø150	672012-1KAA
BE 90 vanes (I) (Ø32mm hose)	2 500 mm	100 mm	Ø150	672010-11AA
		120 mm	Ø150	672012-11AA
DV 60 vanes (K) (Ø32mm hose)	2 500 mm	100 mm	Flange	672110-1KAA
		120 mm	Flange	672112-1KAA
BE 90 vanes (I) (Ø32mm hose)	2 500 mm	100 mm	Flange	672110-11AA
		120 mm	Flange	672112-11AA
DV 60 vanes (K) (Ø32mm hose)	4 000 mm	100 mm	Ø150	672010-1K4A
		120 mm	Ø150	672012-1K4A
BE 90 vanes (I) (Ø32mm hose)	4 000 mm	100 mm	Ø150	672010-114A
		120 mm	Ø150	672012-114A
DV 60 vanes (K) (Ø32mm hose)	4 000 mm	100 mm	Flange	672110-1K4A
		120 mm	Flange	672112-1K4A
BE 90 vanes (I) (Ø32mm hose)	4 000 mm	100 mm	Flange	672110-114A
		120 mm	Flange	672112-114A

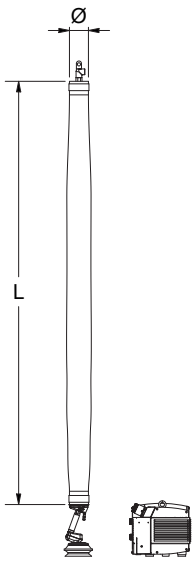

Easyhand Pro Rapid with pump I

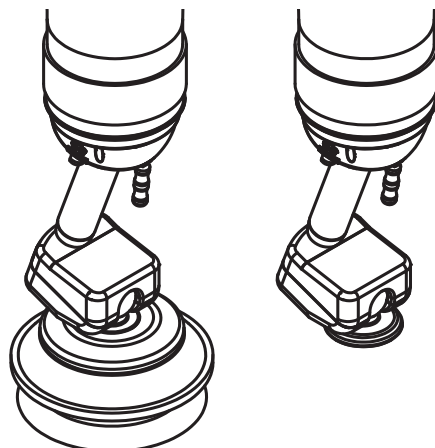
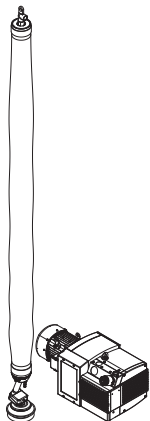

Easyhand Rapid II is always equipped with a combined angle joint 90° + bottom swivel. You can choose between the Ø150 mm bellow suction foot or a flange with the standard 2x M5 to use it with any other Easyhand suction foot / yoke.

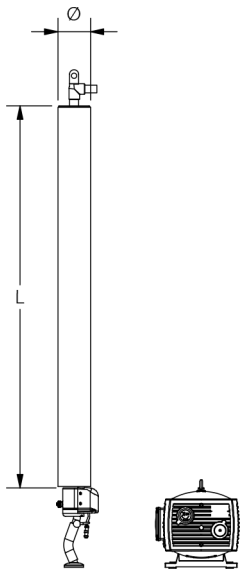

Easyhand Pro with pump C

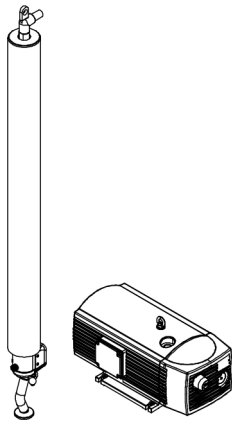

LIFT UNITS, EASYHAND PRO Available in SS

Pump	Length (L)	Diameter (Ø)	Article No.
Ejector PI 100 (A) (Ø25mm hose)	2 500 mm	60 mm	670706-3AAA
		80 mm	670708-3AAA
		100 mm	670710-3AAA
		120 mm	670712-3AAA
Ejector PI 150 (B) (Ø25mm hose)	2 500 mm	60 mm	670706-3BAA
		80 mm	670708-3BAA
		100 mm	670710-3BAA
		120 mm	670712-3BAA
BE 25 vanes (C) (Ø25mm hose)	2 500 mm	60 mm	670706-1CAA
		80 mm	670708-1CAA
		100 mm	670710-1CAA
		120 mm	670712-1CAA
BE 40 vanes (D) (Ø25mm hose)	2 500 mm	60 mm	670706-1DAA
		80 mm	670708-1DAA
		100 mm	670710-1DAA
		120 mm	670712-1DAA
DV 60 vanes (K) (Ø32mm hose)	2 500 mm	60 mm	670706-1KAA
		80 mm	670708-1KAA
		100 mm	670710-1KAA
		120 mm	670712-1KAA
BE 90 vanes (I) (Ø32mm hose)	2 500 mm	60 mm	670706-1IAA
		80 mm	670708-1IAA
		100 mm	670710-1IAA
		120 mm	670712-1IAA
Ejector PI 100 (A) (Ø25mm hose)	4 000 mm	60 mm	670706-3A4A
		80 mm	670708-3A4A
		100 mm	670710-3A4A
		120 mm	670712-3A4A
Ejector PI 150 (B) (Ø25mm hose)	4 000 mm	60 mm	670706-3B4A
		80 mm	670708-3B4A
		100 mm	670710-3B4A
		120 mm	670712-3B4A
BE 25 vanes (C) (Ø25mm hose)	4 000 mm	60 mm	670706-1C4A
		80 mm	670708-1C4A
		100 mm	670710-1C4A
		120 mm	670712-1C4A
BE 40 vanes (D) (Ø25mm hose)	4 000 mm	60 mm	670706-1D4A
		80 mm	670708-1D4A
		100 mm	670710-1D4A
		120 mm	670712-1D4A
DV 60 vanes (K) (Ø32mm hose)	4 000 mm	60 mm	670706-1K4A
		80 mm	670708-1K4A
		100 mm	670710-1K4A
		120 mm	670712-1K4A
BE 90 vanes (I) (Ø32mm hose)	4 000 mm	60 mm	670706-1I4A
		80 mm	670708-1I4A
		100 mm	670710-1I4A
		120 mm	670712-1I4A

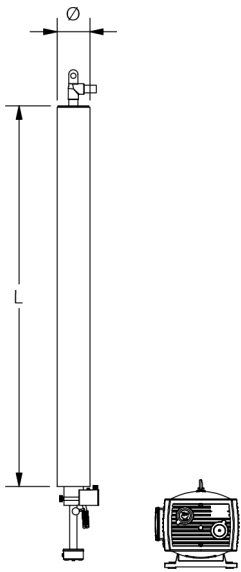

Easyhand M with pump C

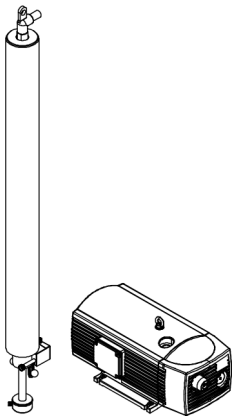

LIFT UNITS, EASYHAND M Available in SS

Pump	Length (L)	Diameter (Ø)	Article No.
Ejector PI 100 (A) (Ø25mm hose)	2 500 mm	60 mm	640706-3AAA
		80 mm	640708-3AAA
		100 mm	640710-3AAA
		120 mm	640712-3AAA
Ejector PI 150 (B) (Ø25mm hose)	2 500 mm	60 mm	640706-3BAA
		80 mm	640708-3BAA
		100 mm	640710-3BAA
		120 mm	640712-3BAA
BE 25 vanes (C) (Ø25mm hose)	2 500 mm	60 mm	640706-1CAA
		80 mm	640708-1CAA
		100 mm	640710-1CAA
		120 mm	640712-1CAA
BE 40 vanes (D) (Ø25mm hose)	2 500 mm	60 mm	640706-1DAA
		80 mm	640708-1DAA
		100 mm	640710-1DAA
		120 mm	640712-1DAA
DV 60 vanes (K) (Ø32mm hose)	2 500 mm	60 mm	640706-1KAA
		80 mm	640708-1KAA
		100 mm	640710-1KAA
		120 mm	640712-1KAA
BE 90 vanes (I) (Ø32mm hose)	2 500 mm	60 mm	640706-1IAA
		80 mm	640708-1IAA
		100 mm	640710-1IAA
		120 mm	640712-1IAA
Ejector PI 100 (A) (Ø25mm hose)	4 000 mm	60 mm	640706-3A4A
		80 mm	640708-3A4A
		100 mm	640710-3A4A
		120 mm	640712-3A4A
Ejector PI 150 (B) (Ø25mm hose)	4 000 mm	60 mm	640706-3B4A
		80 mm	640708-3B4A
		100 mm	640710-3B4A
		120 mm	640712-3B4A
BE 25 vanes (C) (Ø25mm hose)	4 000 mm	60 mm	640706-1C4A
		80 mm	640708-1C4A
		100 mm	640710-1C4A
		120 mm	640712-1C4A
BE 40 vanes (D) (Ø25mm hose)	4 000 mm	60 mm	640706-1D4A
		80 mm	640708-1D4A
		100 mm	640710-1D4A
		120 mm	640712-1D4A
DV 60 vanes (K) (Ø32mm hose)	4 000 mm	60 mm	640706-1K4A
		80 mm	640708-1K4A
		100 mm	640710-1K4A
		120 mm	640712-1K4A
BE 90 vanes (I) (Ø32mm hose)	4 000 mm	60 mm	640706-1I4A
		80 mm	640708-1I4A
		100 mm	640710-1I4A
		120 mm	640712-1I4A

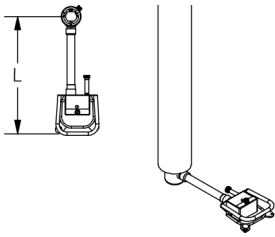

If you would like the extended handle, add the Article No. of the extended handle you want on your order and the control unit will be exchanged to include the operating housing for the extended handle. The Article No. for the lifter doesn't need to be changed.

EXTENDED HANDLE, FIXED, FOR EASYHAND M Available in SS

Length (L)	Article No.
200 mm	640200-002
300 mm	640200-003
400 mm	640200-004
600 mm	640200-006

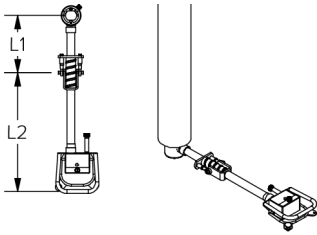

EXTENDED HANDLE, FLEXIBLE, FOR EASYHAND M Available in SS

Length (L1)	Length (L2)	Article No.
200 mm	300 mm	640210-0203
200 mm	500 mm	640210-0205
200 mm	600 mm	640210-0206
300 mm	300 mm	640210-0303
300 mm	500 mm	640210-0305
800 mm	600 mm	640210-0306
400 mm	300 mm	640210-0403
400 mm	500 mm	640210-0405
400 mm	600 mm	640210-0406
500 mm	300 mm	640210-0503
500 mm	500 mm	640210-0505
500 mm	600 mm	640210-0506
800 mm	300 mm	640210-0803
800 mm	500 mm	640210-0805
800 mm	600 mm	640210-0806

2-HAND HANDLE Available in SS

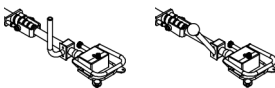

Description	Article No.
Straight	640205-001
Knob	640205-002

FILTER Available in SS

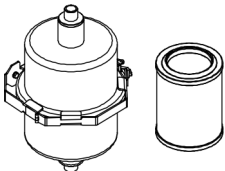

Description	Article No.
Filter unit for Ø25 mm hose	644002
Filter unit for Ø32 mm hose	644005
Filter insert (included in filter unit)	841833

VACUUM HOSE

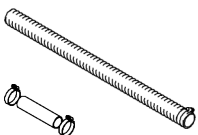

Description	Article No.
Hose Ø25 mm (price/m) (max length/roll 50 m)	641501-025
Hose Ø32 mm (price/m) (max length/roll 50 m)	641501-032
Hose clamp Ø26-38 mm	840506
Joint set Ø25-hose	641501-025-02
Joint set Ø32-hose	641501-032-02

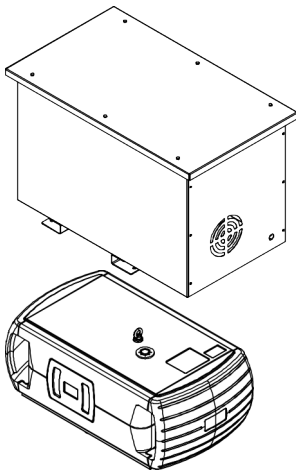

SILENCING BOX

Description	Article No.
For pump C	860074
For pump D	860067
For pump C *	860074-10
For pump D *	860067-10
For pump I	860066-10
For pump K	860066-20

* when bought without pump

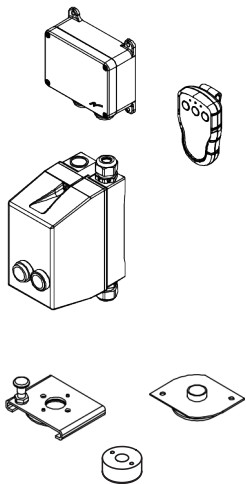

REMOTE CONTROL FOR VACUUM PUMP

Description	Article No.
Radio control 4,0-6,0A For pump I	744977
Radio control 2,5-4,0A For pumps D & K	744978
Radio control 1,6-2,5A For pump C	744979

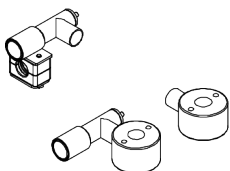

QUICK CONNECTION Available in SS

Description	Height	Article No.
Quick connection upper	Lower + upper 25 mm	100960
Quick connection lower		100961
Distance for Rapid II *	30 mm	672038

* Needed when using a quick connection on Easyhand Rapid II with flange.



ANGLE JOINT / BOTTOM SWIVEL Available in SS

Description	Height	Article No.
Angle joint 90°	89 mm	100970
Bottom swivel	58 mm	100975
Bottom swivel, long screws *	58 mm	100975-50
Bottom swivel double bearing	58 mm	100976
Bottom swivel double bearing, long screws *	58 mm	100976-50
Bottom swivel 4 position	58 mm	100977
Bottom swivel 4 position, long screws *	58 mm	100977-50
Combined angle joint 90° + bottom swivel	64 mm	670050
Adapter plate **	13 mm	670048

* Swivels with long screws are used when combining a swivel with a release valve.

** The adapter plate 670048 enables mounting of all suction feet with the standard 2x M5 fastening.

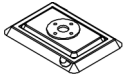

RECTANGULAR SUCTION FEET, SINGLE

Length	Width	Height	Article No.
200 mm	85 mm	24 mm	642001
315 mm	120 mm	24 mm	642002
200 mm	140 mm	24 mm	642003



ROUND BELLOW SUCTION FEET, STANDARD

Diameter	Height	Thread	Article No.
150 mm	80 mm	1/2" thread	860049-20
150 mm	80 mm	1/2" thread + 2x Ø5,5	860049-30
150 mm	80 mm	1/2" thread	860049-FDA *

* Food grade rubber

1/2" thread can only be mounted to the Combined angle joint 90° + bottom swivel, article no. 670050

1/2" thread + 2x Ø5,5 thread can be mounted to any combination

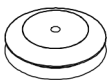

ROUND BELLOW SUCTION FEET, BASIC

Diameter	Height	Thread	Article No.
150 mm	42 mm	1/2" thread	860049-40
200 mm	50 mm	1/2" thread	860050-01

1/2" thread can only be mounted to the Combined angle joint 90° + bottom swivel, article no. 670050

1/2" thread + 2x 5,5 thread can be mounted to any combination

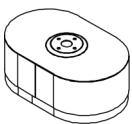

SACK SUCTION FEET Available in SS

Length	Width	Height	Article No.
185 mm	115 mm	72 mm	642201
290 mm	154 mm	76 mm	642202
275 mm	175 mm	106 mm	642203
245 mm	125 mm	60 mm	642206



GRID FOR SACK SUCTION FEET Available in SS

Description	Article No.
Grid for 642201	642201-01
Grid for 642202	642202-01
Grid for 642203	642203-01
Grid for 642206	642206-01

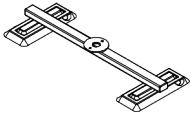

YOKE FIXED, 2X RECTANGULAR SUCTION FEET

Suction feet		Yoke		
Length	Width	Length	Height	Article No.
200 mm	85 mm	300 mm	54 mm	642405-030
		500 mm	54 mm	642405-050
		800 mm	54 mm	642405-080
		1000 mm	54 mm	642405-100

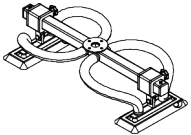

YOKE FLEXIBLE, 2X RECTANGULAR SUCTION FEET

Suction feet		Yoke		
Length	Width	Length	Height	Article No.
200 mm	85 mm	500 mm	120 mm	642400-050
		800 mm	120 mm	642400-080
		1200 mm	120 mm	642400-120

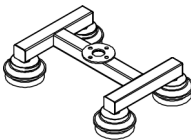

H-YOKE FIXED, 4X ROUND BELLOW SUCTION FEET

Diameter	Length	Width	Height	Article No.
75 mm	230 mm	190 mm	79 mm	642425-001
	325 mm	185 mm	79 mm	642425-003
	325 mm	235 mm	79 mm	642425-005
110 mm	330 mm	230 mm	111 mm	642425-006

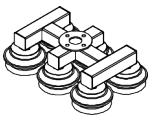

H-YOKE FIXED, 6X ROUND BELLOW SUCTION FEET

Diameter	Length	Width	Height	Article No.
75 mm	260 mm	170 mm	79 mm	642426-001

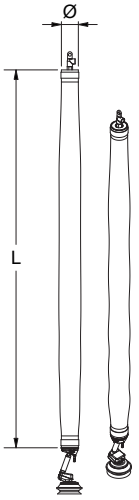

TUBE LIFTER, EASYHAND RAPID II *

Length (L)	Diameter (Ø)	Interface	Article No.
2500 mm	100 mm	Ø150	672010-10
	120 mm	Ø150	672012-10
	100 mm	Flange	672110-10
	120 mm	Flange	672112-10
4000 mm	100 mm	Ø150	672010-14
	120 mm	Ø150	672012-14
	100 mm	Flange	672110-14
	120 mm	Flange	672112-14

* A hose connection to the top swivel is required.

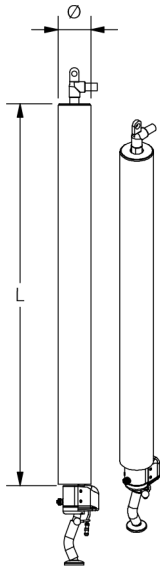

TUBE LIFTER, EASYHAND PRO *

Length (L)	Diameter (Ø)	Article No.
2500 mm	60 mm	670706-10
	80 mm	670708-10
	100 mm	670710-10
	120 mm	670712-10
4000 mm	60 mm	670706-14
	80 mm	670708-14
	100 mm	670710-14
	120 mm	670712-14

* A hose connection to the top swivel is required.

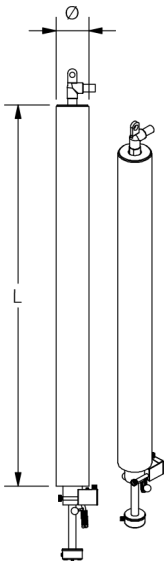

TUBE LIFTER, EASYHAND M *

Length (L)	Diameter (Ø)	Article No.
2500 mm	60 mm	640706-10
	80 mm	640708-10
	100 mm	640710-10
	120 mm	640712-10
4000 mm	60 mm	640706-14
	80 mm	640708-14
	100 mm	640710-14
	120 mm	640712-14

* A hose connection to the top swivel is required.



HOSE CONNECTION, TOP SWIVEL

Description	Diameter (Ø)	Article No.
For C & D pump	25 mm	840040-083
For K & I pump	32 mm	840040-094

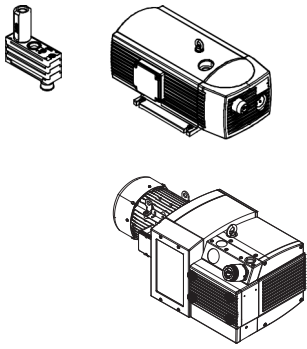

PUMPS

Description	Article No.
Airpressure PI 100	660001-A10
Airpressure PI 150	660001-B15
Electric BE 25 vanes	660001-C25
Electric BE 40 vanes	660001-D40
Electric BE 60 vanes	660001-K60
Electric BE 90 vanes	660001-I90



HOSE CONNECTION, PUMP

Description	Diameter (Ø)	Article No.
For C & D pump	25 mm	840040-093
For K & I pump	32 mm	840040-096

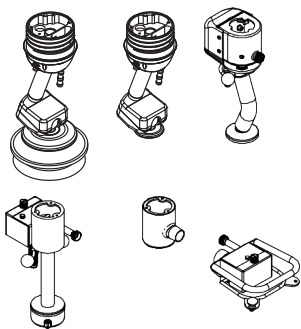

CONTROL UNITS

Description	Diameter (Ø)	Height	Article No.
Easyhand Pro Rapid II Ø150	100 mm	305 mm	672010
Easyhand Pro Rapid II Flange	100 mm	232 mm	672110
Easyhand Pro Rapid II Ø150	120 mm	305 mm	672012
Easyhand Pro Rapid II Flange	120 mm	232 mm	672112
Easyhand Pro		262 mm	670700
Easyhand M Standard		233 mm	170000
Easyhand M Extended Housing		51 mm	180201
Easyhand M Extended Handle		-	180100

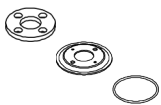

GASKETS

Description	Height	Article No.
Gasket lift/tool	6 mm	170140-10
Gasket quick connection upper	-	100960C
O-ring quick connection upper	-	100960D

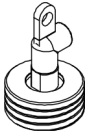

TOP SWIVELS

Diameter	Article No.
60 mm	170450
80 mm	170451
100 mm	170452
120 mm	170453



PLASTIC ADAPTERS

Diameter	Article No.
60 mm	170437
80 mm	170438
100 mm	170439
120 mm	170440
Gasket	170407-1
Plastic adapter distance*	670028

* Required for mounting Easyhand Pro on the Ø100 and Ø120 plastic adapters.



LIFT TUBES

Length	Diameter	Article No.
2500 mm	60 mm	640421
	80 mm	640431
	100 mm	640441
	120 mm	640451
4000 mm	60 mm	640421-04
	80 mm	640431-04
	100 mm	640441-04
	120 mm	640451-04



PROTECTIVE SOCKS

Length	Diameter	Article No.
2500 mm	60 mm	6050460
	80 mm	6050461
	100 mm	6050462
	120 mm	6050463
4000 mm	60 mm	6050550
	80 mm	6050551
	100 mm	6050552
	120 mm	6050553



COMPLETE LIFT TUBE UNITS *

Length	Diameter	Article No.
2500 mm	80 mm	640435-10
	100 mm	640445-10
	120 mm	640455-10
4000 mm	80 mm	640435-14
	100 mm	640445-14
	120 mm	640455-14

* A hose connection to the top swivel is required. See p. 28

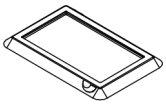

GASKET NBR Suitable for general indoor use, oil resistant, standard for all our suction feet

Length	Width	Article No.
200 mm	85 mm	860038-10
200 mm	140 mm	860027-10
315 mm	120 mm	860048-10

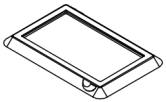

GASKET EPDM Suitable for general outdoor use

Length	Width	Article No.
200 mm	85 mm	860038-01
200 mm	140 mm	860027-01
315 mm	120 mm	860048-01

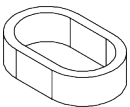

GASKET FOR SUCTION FEET, SACKS

Description	Length	Width	Article No.
Fits 642201	185 mm	115 mm	642201-03
Fits 642202	290 mm	154 mm	642202-03
Fits 642203	275 mm	175 mm	642203-03
Fits 642206	245 mm	125 mm	642206-03

SPARE PARTS VACUHAND PRO

Item	Qty.	Description	Article No.
2	1	Operating handle	640002
3	2	Handle	640003
4	1	Valve - Bottom	640004
6	1	Rubber spacer - Main valve	641006
8	1	Spring - Botom valve adjustment	640023
9	1	Adjustment screw - Bottom valve	640024
10	1	Adjustment knob - Bottom valve	640025
11	1	Valve - Maneuver	640026
13	1	Adjustment knob - Main	640028
14	1	Rubber bellow - Main	640029
15	1	Rubber bellow - Bottom valve adj.	640030
16	1	End stop	640031
17	1	Pressure spring	640032
18	3	Pressure spring	640033
19	4	Bushing 8x15	640035
30	1	Plastic bearing	640034
8, 9, 10 & 15		Adjustment without load - Kit	640050

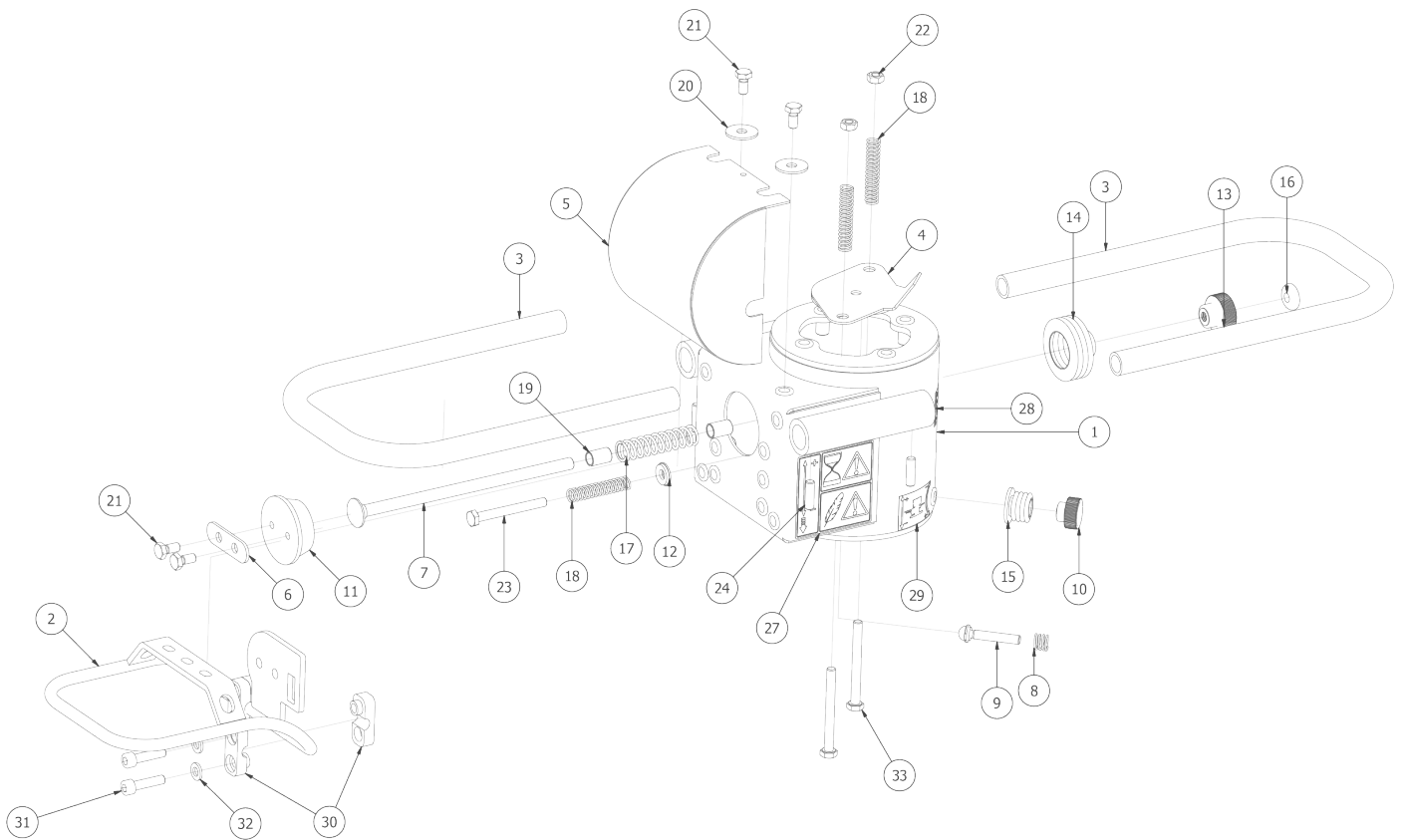

SPARE PARTS EASYHAND RAPID II

Item	Qty.	Description	Article No.
2	1	Rubber handle	A-672036
3	1	Finger-grip manouvre-lever	670027
4	1	Adjustment screw	672025
5	1	Joint, lower housing	672035
6	1	KM nut special M25x1,5	KM05
7	1	Cover Rapid II	672026
8	1	Joint, upper housing	672034
9	1	Joint ball	672039
14	4	Spring stainless NA	170141
17	1	Chock valve	672027
20	1	Valve-cone Rapid II	672022-1-4

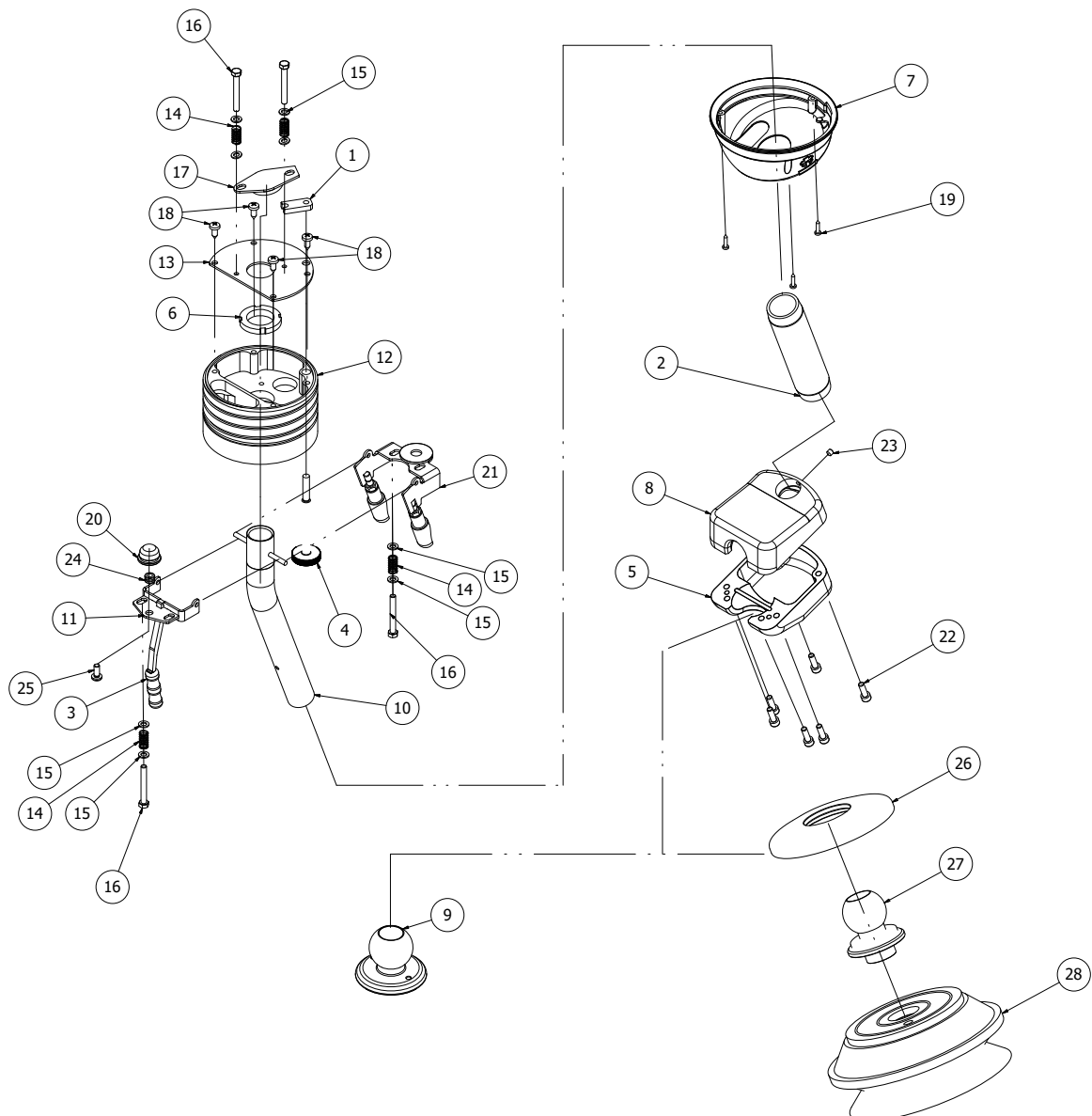

SPARE PARTS EASYHAND PRO

Item	Qty.	Description	Article No.
1	1	O-ring 15	170113
2	6	Bearing for maneuver handle	640034
3	1	Gasket PLD ML	170407-1
9	1	Cover Pro/Rapid	670008
11	2	Spring SS	170141
12	1	KM nut special M22x1,5	670017
13	1	Bottom valve	670003
16	1	Coned valve	670007
21	1	Maneuver knob	670027
23	1	Gasket vacuum housing lower	670013

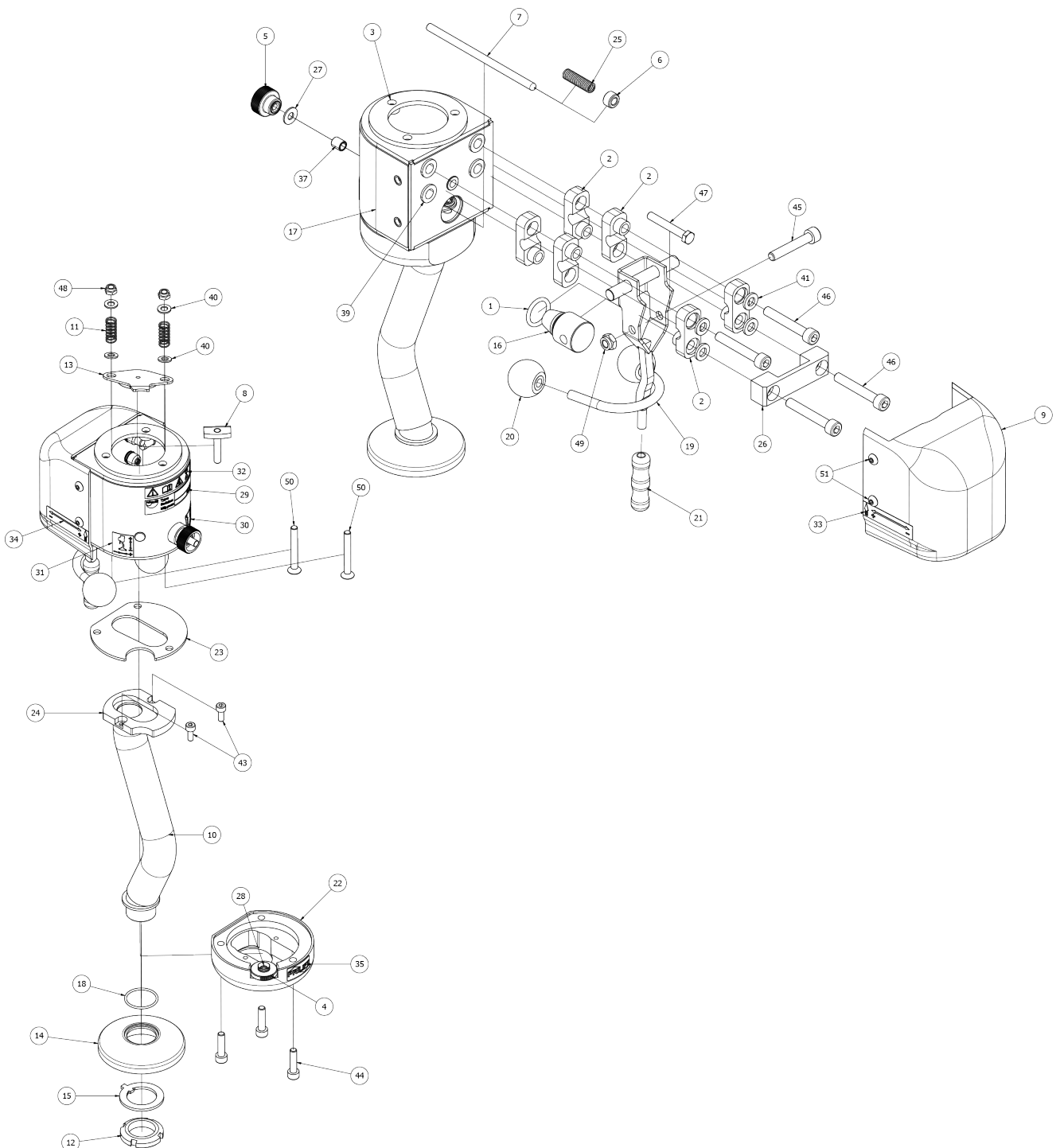

SPARE PARTS EASYHAND M

Item	Qty.	Description	Article No.
2	2	Bearing complete	170110
3	1	O-ring Manoeuvre valve ML	170113
4	1	Valve manoevre unit ML	170114
5	1	Washer locking	170115
6	2	Knob	170117
7	1	Handle ML 8x70	170118
8	1	Maneuver control	170119
9	1	Spring turn	170120
10	1	Adjustable body ML	170130
12	1	Bolt M5x75 special unit ML	170132
13	1	Spring 58mm	170133
14	1	Letternut LN26 20 M5	170134
15	1	Spring, extended manoevre unit	170137
16	1	Gasket 67x28x4 HC 45x4x10	170140
17	2	Spring stainless NA	170141
18	1	Valve	170143
19	1	Housing	170144
20	2	Bolt M6S M5x35 spec.	170145
21	1	Balance screw without load compl.	170146
23	1	Cover	170304

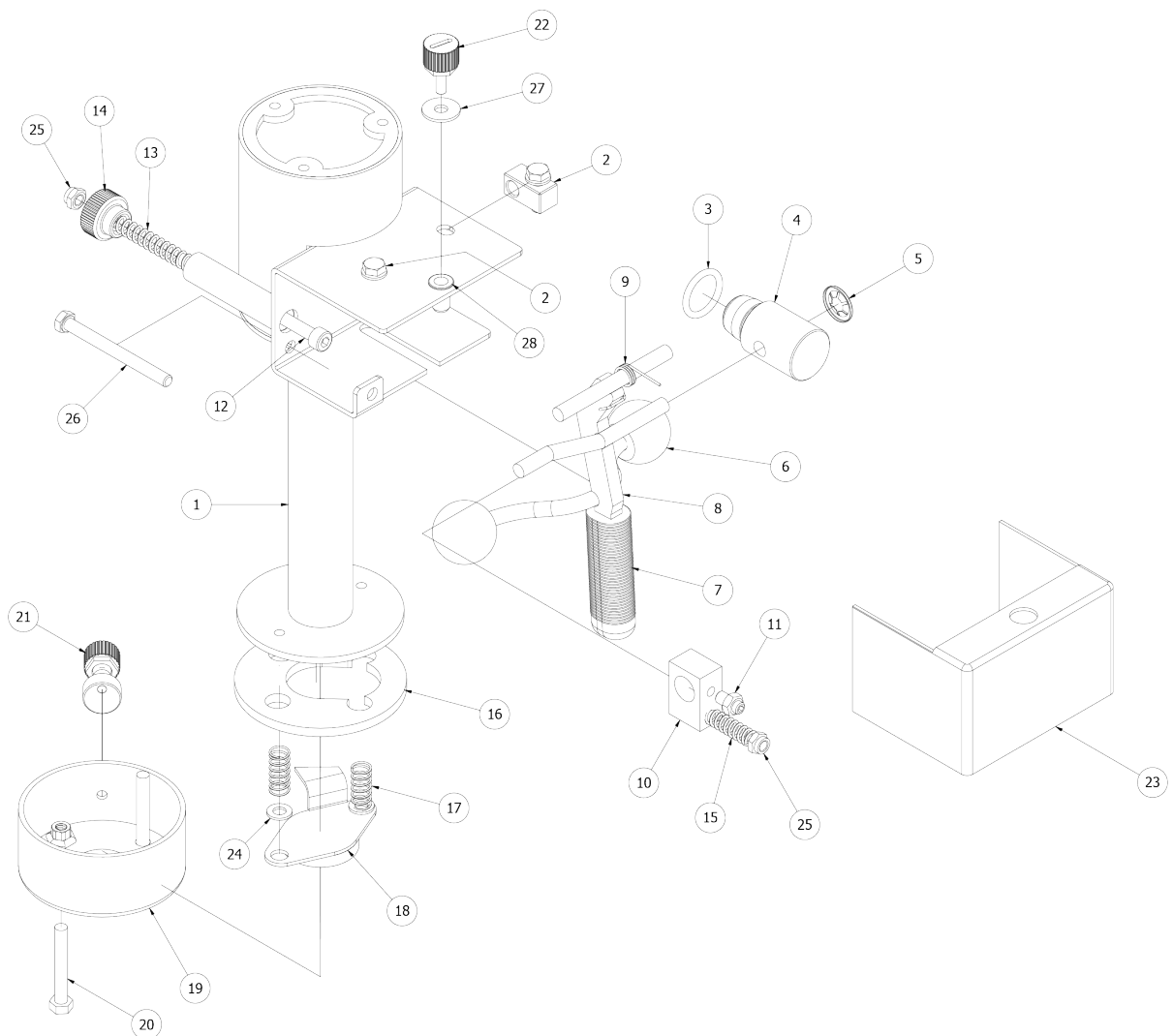

SPARE PARTS EASYHAND M, EXTENDED HANDLE

Item	Qty.	Description	Article No.
4	1	O-ring Manoeuvre valve ML	170113
5	1	Valve manoeuvre unit ML	170114
6	1	Washer locking	170115
7	1	Adjustable body ML	170130
9	1	Bolt M5x75 special unit ML	170132
10	1	Spring 58mm	170133
11	1	Letter nut	170134
13	1	Spring, extended manoeuvre unit	170137
14	2	Spring stainless NA	170141
15	1	Valve	170143
16	1	Balance screw without load compl.	170146
18	1	Cover	180104
19	1	Manoeuvre handle ext.	180105
21	2	Bushing, special	180110
23	1	Thumb button	180112

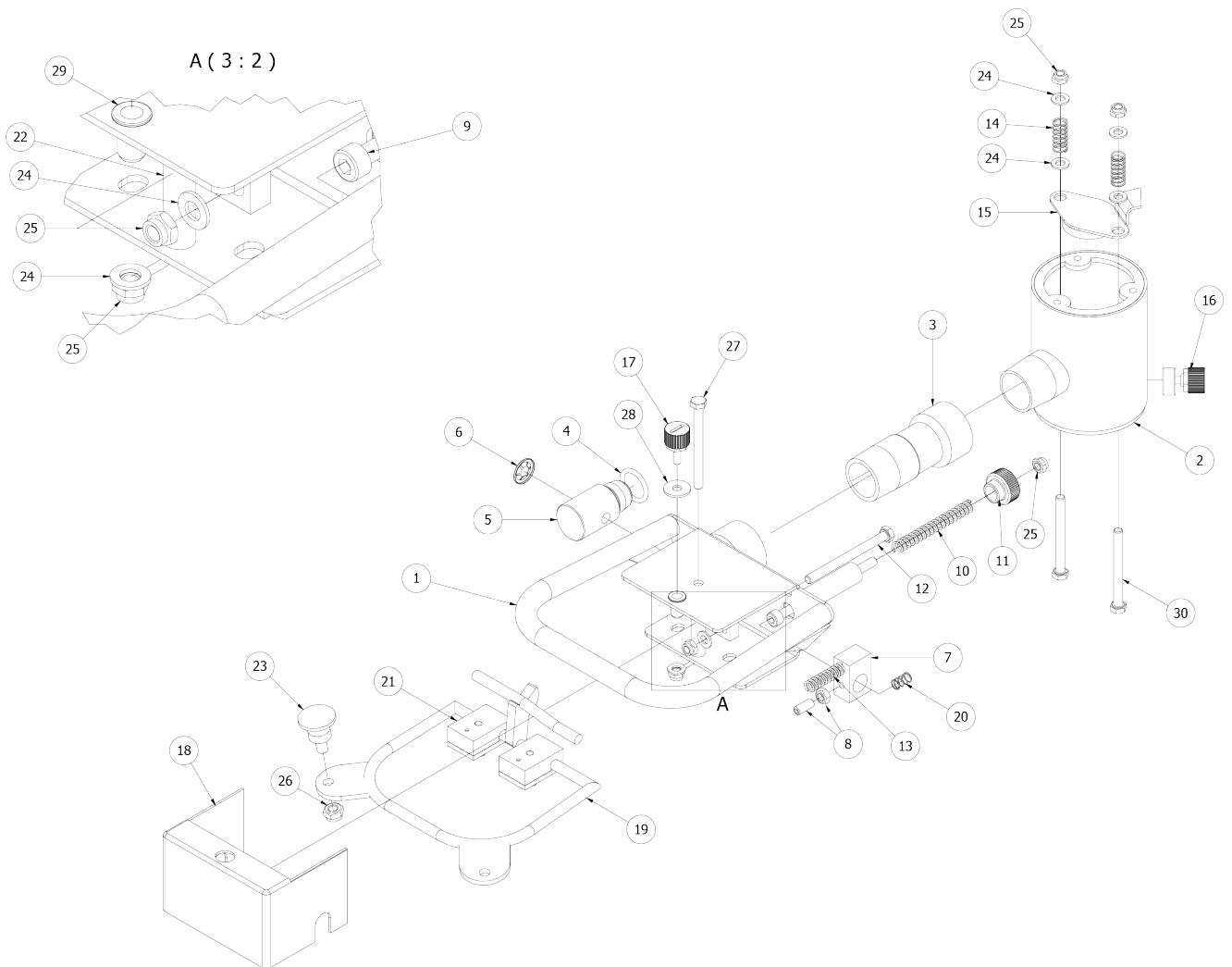

SPARE PARTS FILTER UNIT

Item	Qty.	Description	Article No.
4	2	Sealing strip	644001-04
8	1	Inner-lid filter	841132
9	1	Star knob for filter lid	841416
11	1	Air filter	841833

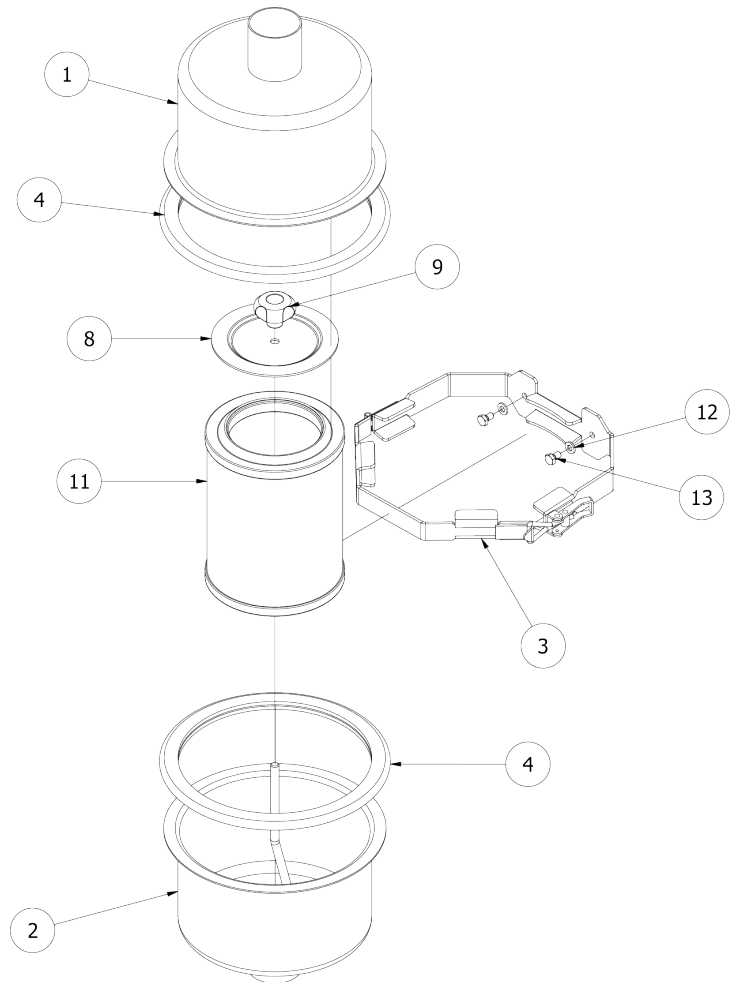

SPARE PARTS PUMP C

Item	Qty.	Description	Article No.
24	1	Carbon vanes kit	901349 00007
72	1	Filter cartridge	909505 00000

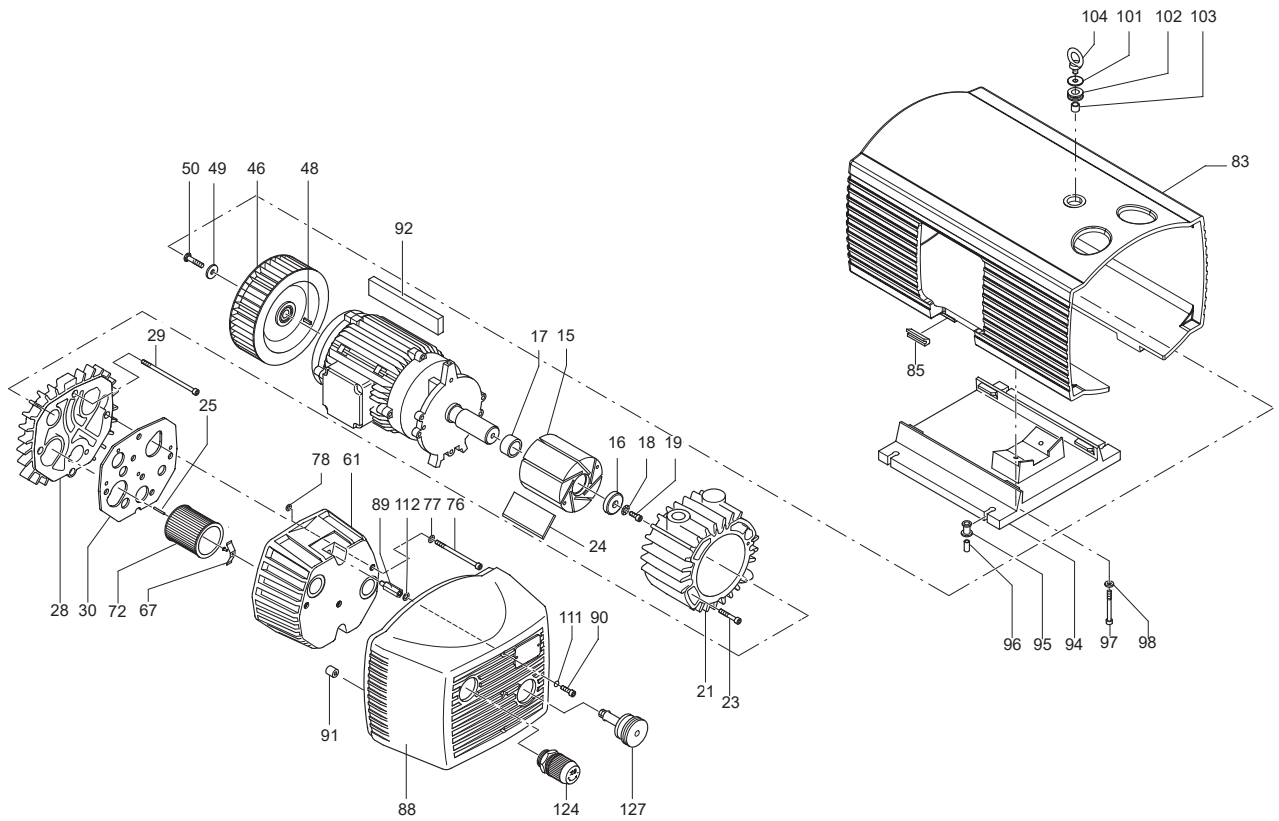

SPARE PARTS PUMP D

Item	Qty.	Description	Article No.
24	1	Carbon vanes kit	901352 00007
72	1	Filter cartridge	909505 00000

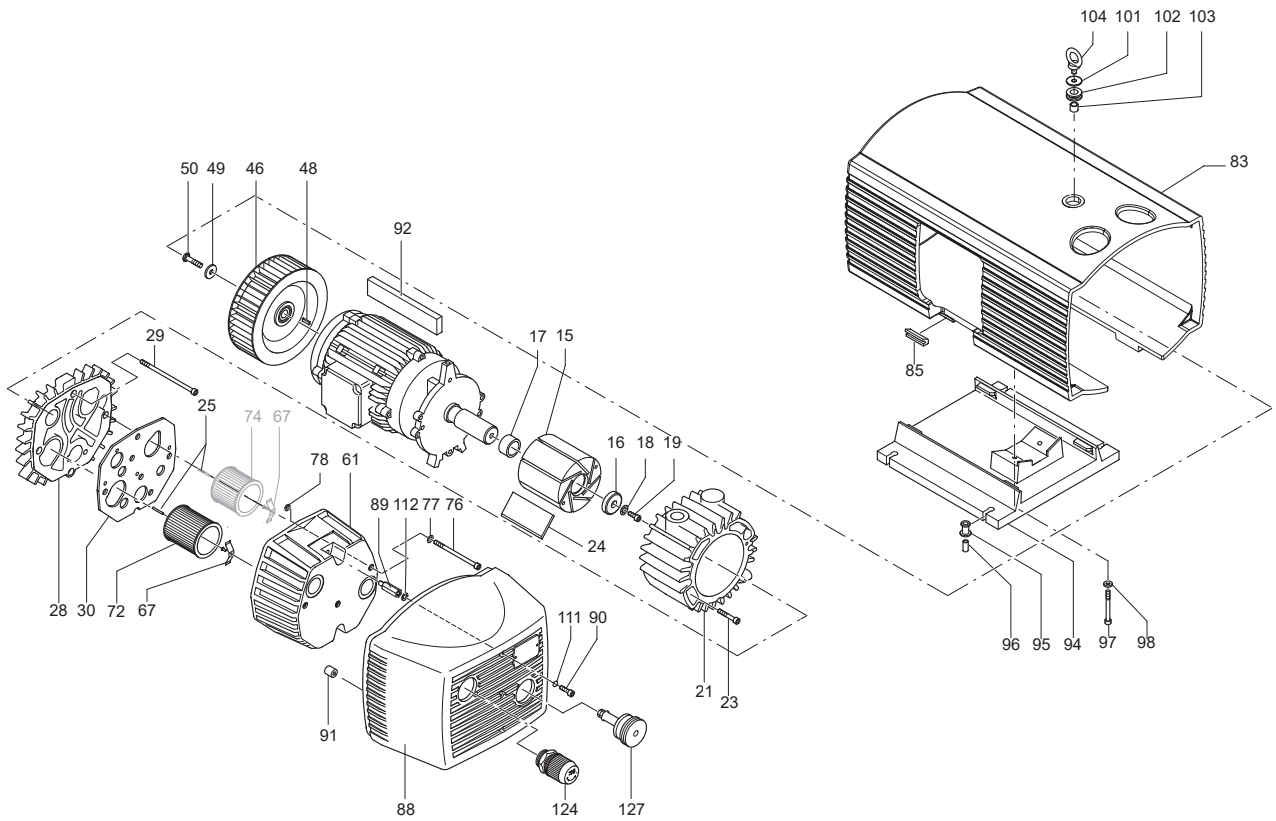

SPARE PARTS PUMP K

Item	Qty.	Description	Article No.
-	1	Set of seals - Pos.: 20, 24, 62, 75, 76, 85, 86, 104, 125, 126, 127, 146, 288	549000 21100
11	1	Carbon vanes kit	901330 00004
68	1	Filter cartridge C 1112/2	909507 00000
91	1	Filter cartridge C 713	909510 00000
-	1	Special grease tube, 8g	960000 02300

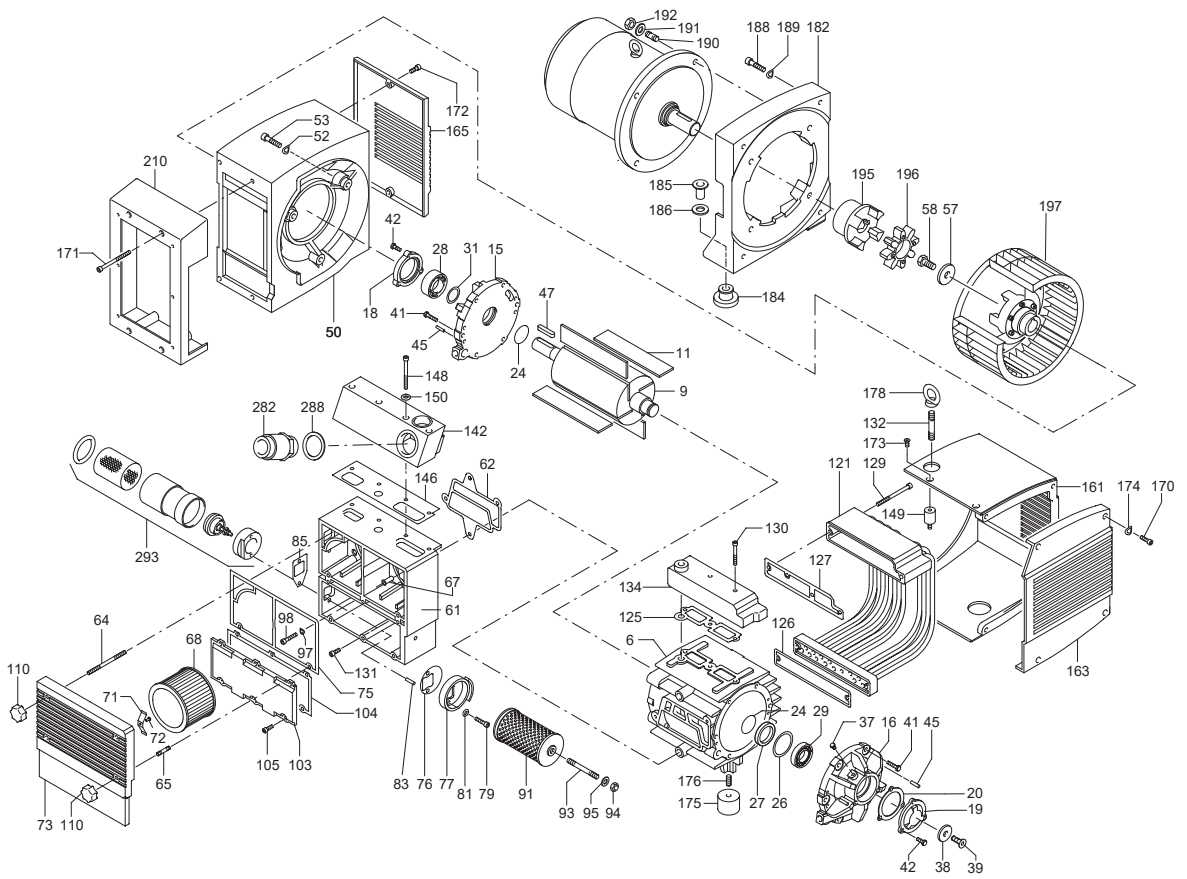

SPARE PARTS PUMP I

Item	Qty.	Description	Article No.
-	1	Set of seals - Pos.: 20, 24, 62, 75, 76, 85, 86, 104, 125, 126, 127, 146, 288	549000 21100
11	1	Carbon vanes kit	901330 00004
68	1	Filter cartridge C 1112/2	909507 00000
91	1	Filter cartridge C 713	909510 00000
-	1	Special grease tube, 8g	960000 02300

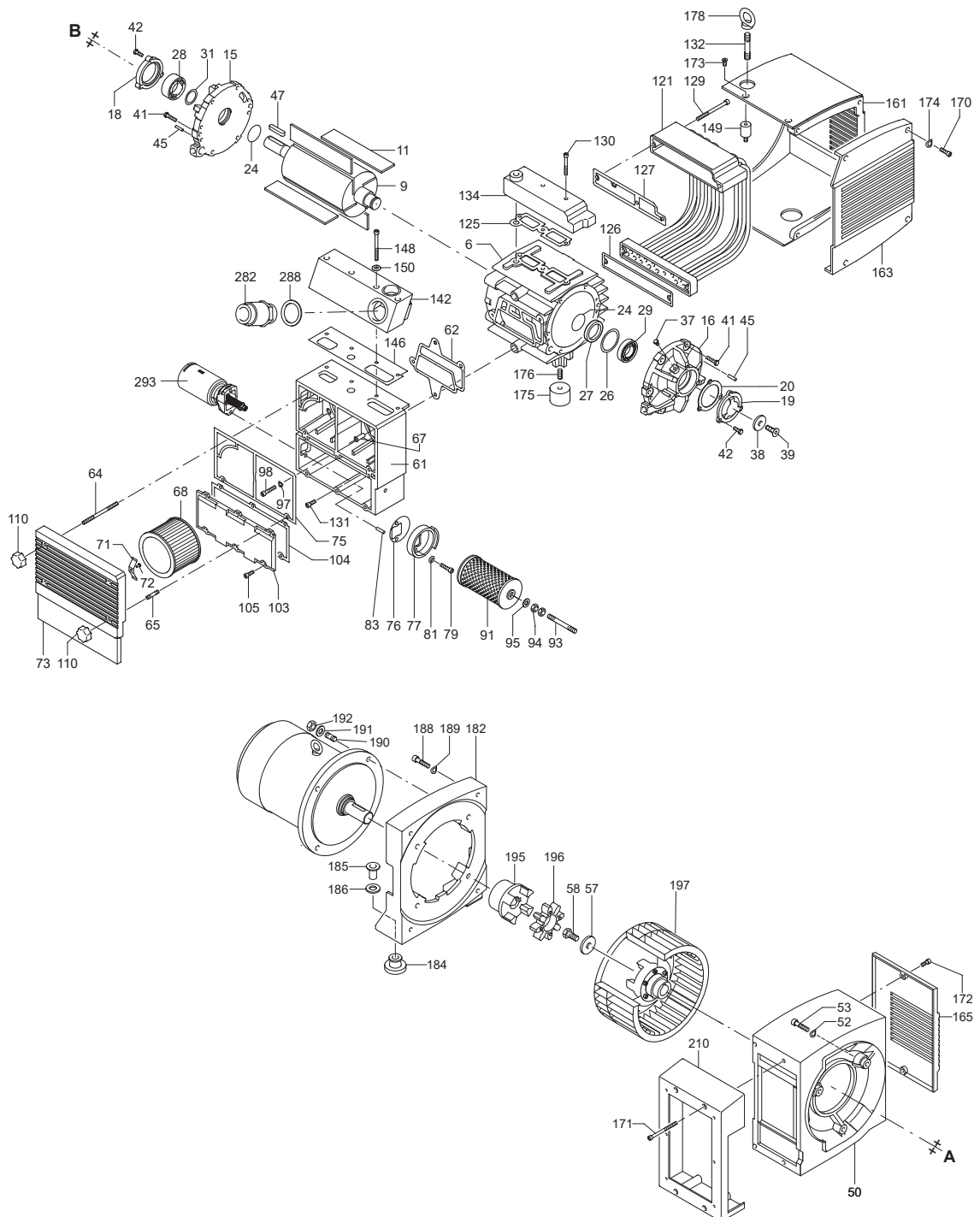

SPARE PARTS PUMP F

Item	Qty.	Description	Article No.
4	1	Vacuum pump BE 2,2 side	660002-F22
5	1	Gas spring 350N	643002
6	1	Electric motor 3-phase 2,2kW	841090-01
7	1	Aluminium pulley Ø56 - d24	643003
9	1	Muffler for pump F	643020
10	1	Taper lock bushing 1610-24	841358-03
11	1	Poly-V Pulley 8J112	841480-02
12	1	Poly-V belt PJ 584 - 8 ribs	842180-07

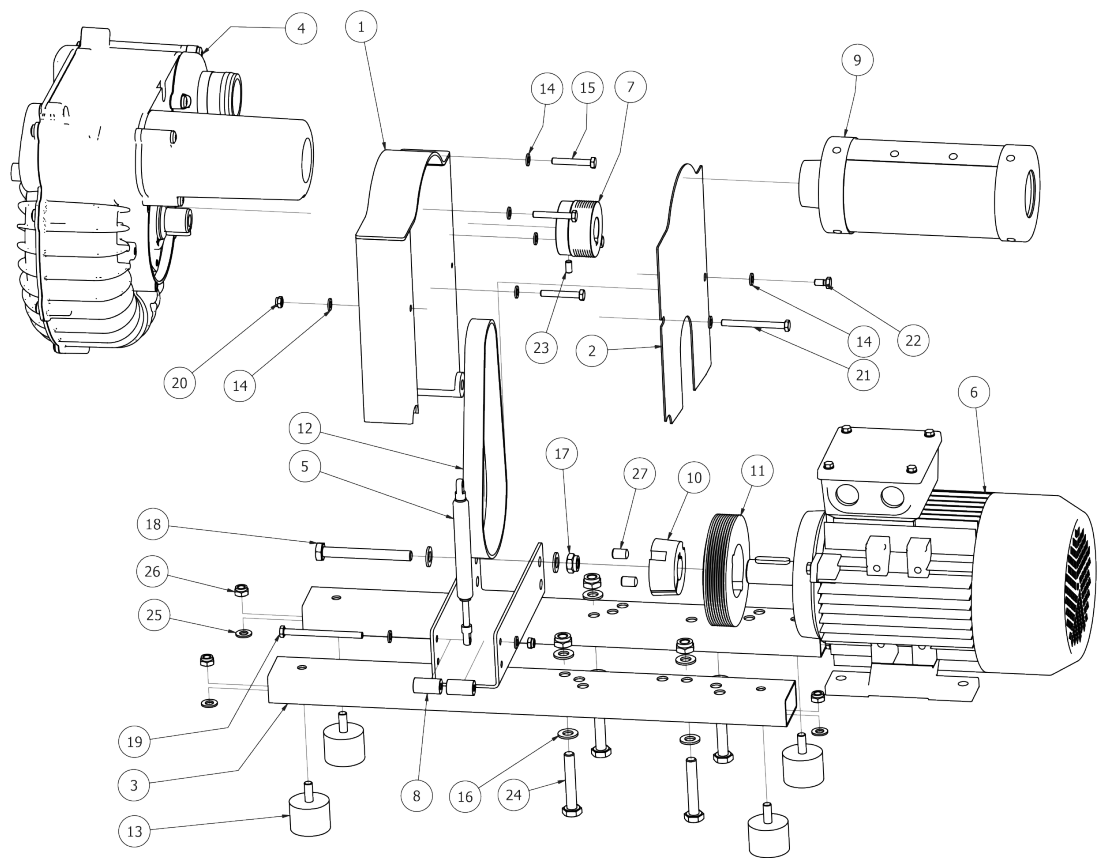

SPARE PARTS PUMP G

Item	Qty.	Description	Article No.
4	1	Vacuum pump BE 3,0 side	660002-G30
5	1	Gas spring 350N	643002
6	1	Aluminium pulley Ø56 - d24	643003
8	1	Electric motor 3-phase 3kW	643007
9	1	Muffler for pump G	643021
10	1	Poly-V belt PJ 559 - 8 ribs	842180-05
11	1	Poly-V pulley Ø118	842180-08
12	1	Taper lock bushing 1610-28	643080-01

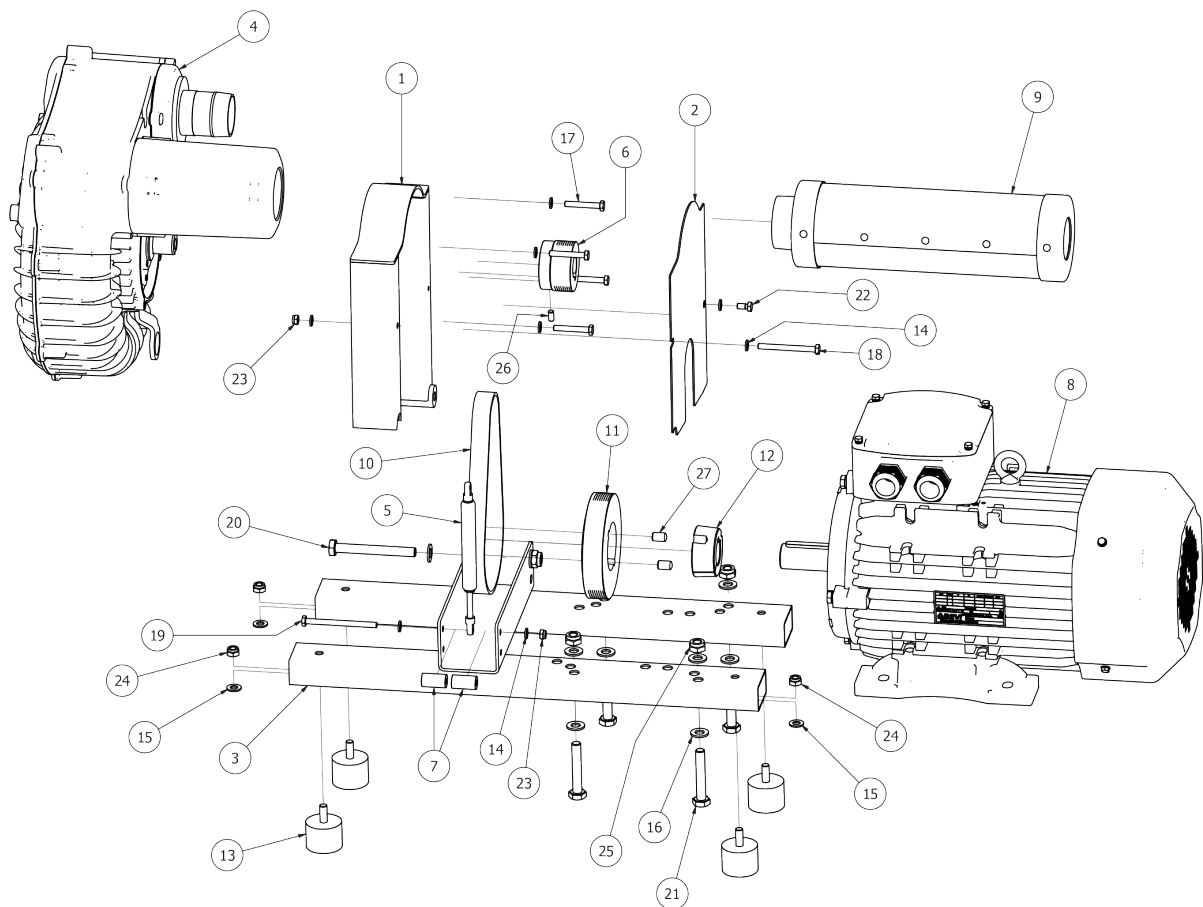

SPARE PARTS PUMP H

Item	Qty.	Description	Article No.
4	1	Vacuum pump FPZ 5,5 side	660002-H55Z
5	1	Electric motor 3-phase 5,5 kW	643008
6	1	Gas spring 300N	643009
8	1	Muffler for pump H	643023
9	1	Taper lock bushing 1610-28	643080-02
10	1	Aluminium pulley Ø56 - d28	643011
11	1	Poly-V pulley 8J112	841480-02
12	1	Poly-V belt PJ 584 - 8 ribs	842180-07

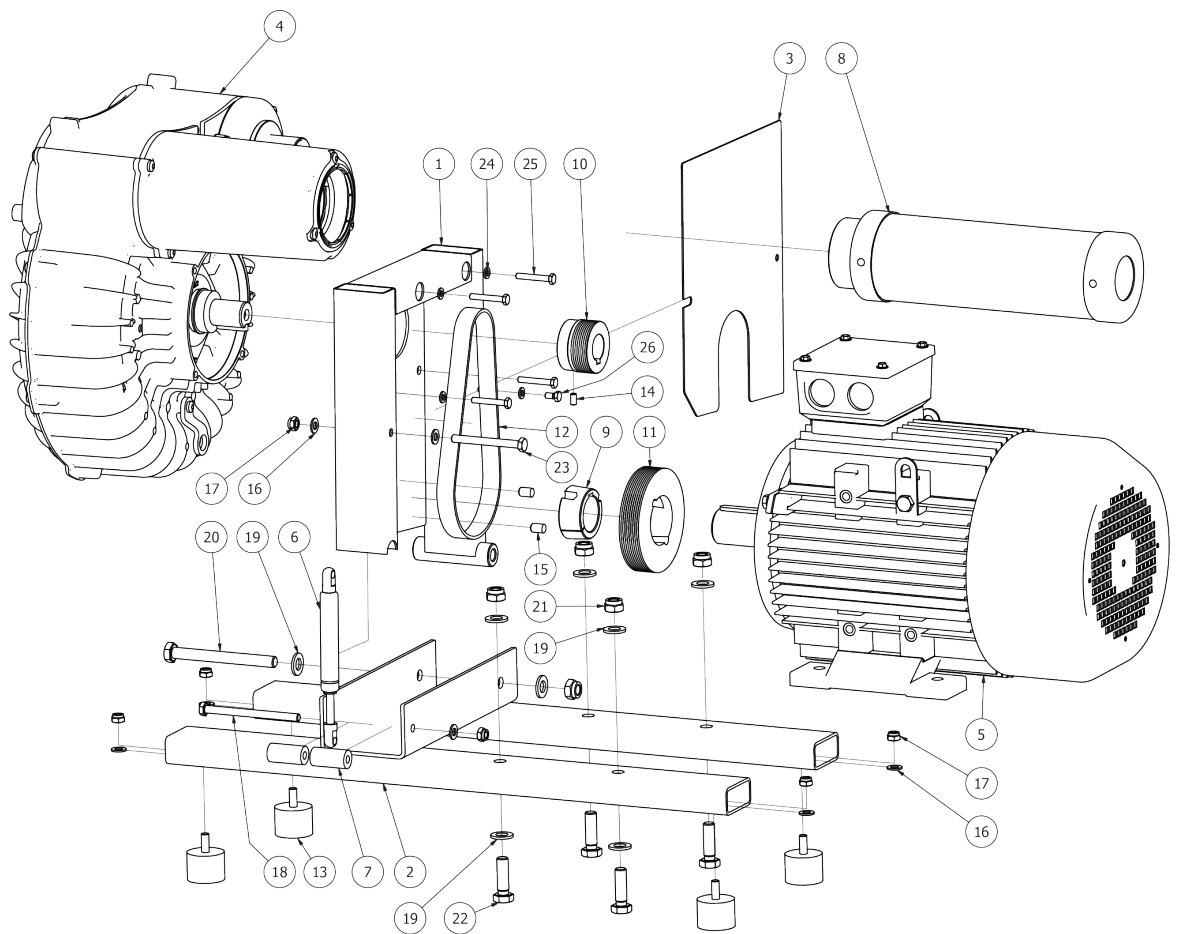

SPARE PARTS EASYHAND PRO RAPID (LEGACY VERSION)

Item	Qty.	Description	Article No.
3	1	Valve	670003
5	1	Valve-cone Rapid	670007
6	1	Cover vacum-housing	670008
7	1	Gasket lower vacum-housing	670013
8	1	KM nut special M22x1,5	670017
11	1	Finger-grip manouvre-lever	670027
13	1	Countersunk attachment-plate	670031
14	1	O-ring 17x2,5	670033
19	4	Plastic bearing	640034
21	2	Spring stainless NA	170141

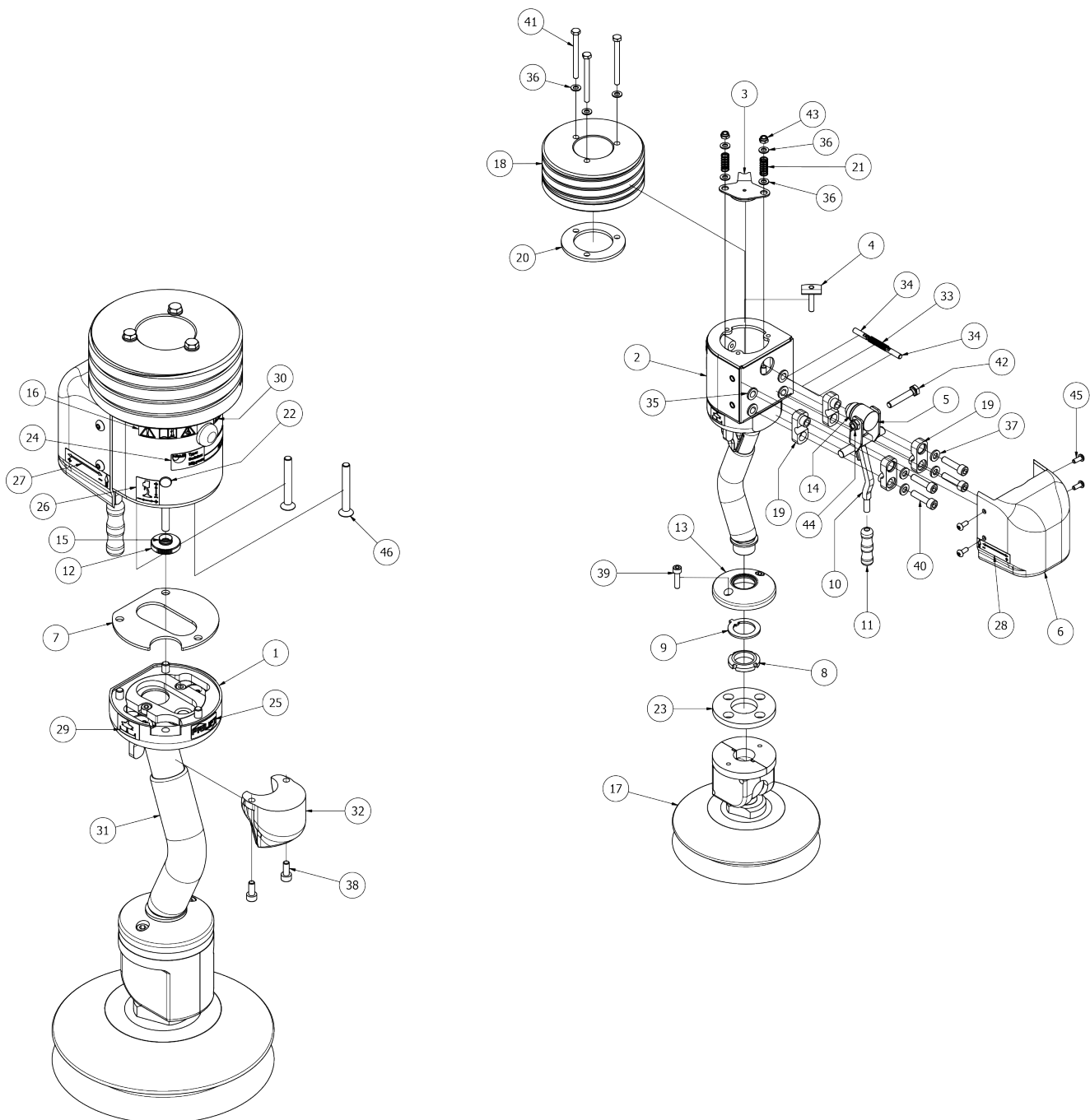

ASSEMBLY LEGEND VACUHAND

Vacuhand Pro Standard

M6, 4x

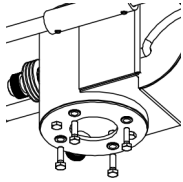

Vacuhand Pro Extended

M6, 4x

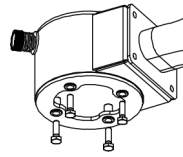

Quick connection upper

Ø7 through, countersunk, 4x

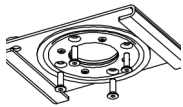

Quick connection lower

M6, 4x

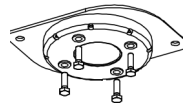

Release valve

Ø7 through, 4x

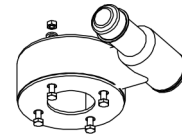

Angle joint

Ø7 through, 4x

M6, 4x

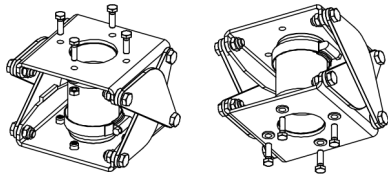

Bottom swivel

Ø7 through, 4x

M6, 4x



Bottom swivel 4-way

Pre mounted M6, 4x M6, 4x



Universal joint

Ø7 through, 4x

Ø7 through, 4x

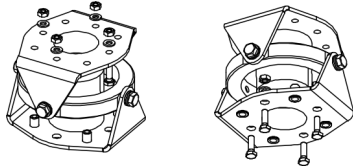

Suction feet, single

Ø7 through, 4x

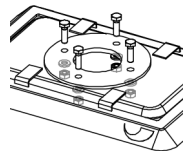

Suction feet, double

Ø7 through, 4x

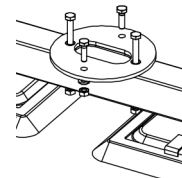

Sack suction feet

Ø7 through, 4x

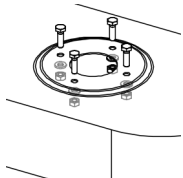

Round suction feet

Ø7 through, 4x

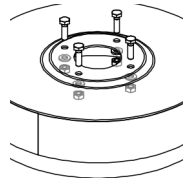

Yoke fixed

Ø7 through, 4x

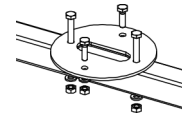

Yoke flexible

Ø7 through, 4x

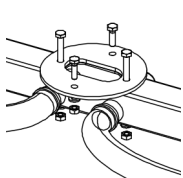

H-yoke fixed

Ø7 through, 4x

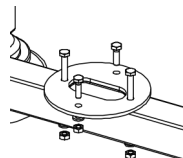

H-yoke flexible

Ø7 through, 4x

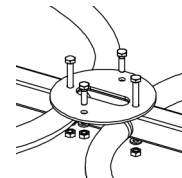

ASSEMBLY LEGEND EASYHAND

Easyhand Pro

Ø5,5 through, counterbored Ø12, 2x



Quick connection upper

Ø5,5 through, countersunk, 2x

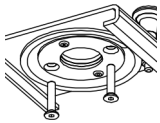

Angle joint

Ø5,5 through, 4x

M5, 4x

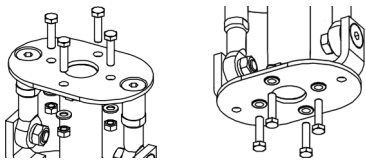

Adapter plate

G1/2" & Ø5,5 through, counterbored Ø12, 2x

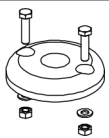

Sack suction feet

Ø5,5 through, 4x

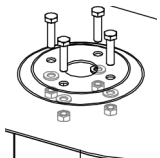

H-yoke fixed

Ø5,5 through, 4x

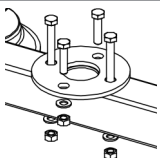

Easyhand Rapid II

M5, 2x

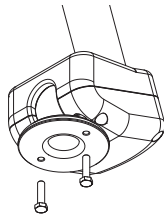

Quick connection lower

M5, 4x

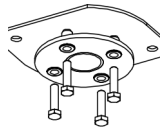

Bottom swivel

Pre-mounted M5, 2x

M5, 2x

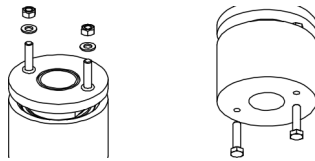

Suction feet, single

Ø5,5 through, 4x

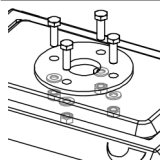

Yoke fixed

Ø5,5 through, 2x

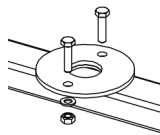

Easyhand M

M5, 2x

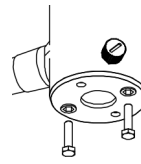

Release valve

Ø5,5 through, 2x

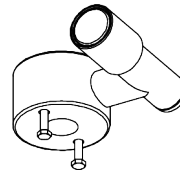

Combined angle joint 90° + bottom swivel

M5, 2x

G1/2"

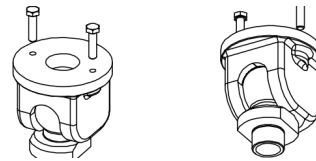

Round bellow suction feet

G1/2"

G1/2" & Ø5,5 through, 2x

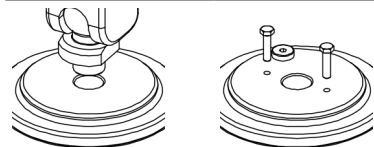

Yoke flexible

Ø5,5 through, 4x

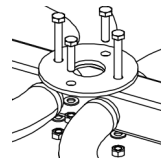

WORLD-CLASS LIFTING SOLUTIONS



Movomech AB +46 (0)44 28 29 00
www.movomech.se